

3449710

DISPOSITIVO PER CONNESSIONE APOLINK

APOLINK CONNECTING DEVICE

MANUALE D'INSTALLAZIONE



INSTALLATION MANUAL



IT

Leggere attentamente le avvertenze contenute nel presente libretto in quanto forniscono importanti indicazioni riguardanti la sicurezza, d'uso e di manutenzione.

Conservare con cura questo libretto per ogni ulteriore consultazione dei vari operatori.

Il costruttore si riserva il diritto di apportare modifiche al presente manuale, senza preavviso e responsabilità alcuna.

GB

Carefully read the instructions contained in the handbook. You may find important safety instructions and recommendations for use and maintenance.

Please retain the handbook for future reference.

The Manufacturer is not liable for any changes to this handbook, which may be altered without prior notice.

3449710

ACCESSORIO



Dotazione accessorio

**SCHEDA DI CONTROLLO
APOLINK**



**SCHEDA APOLINK INSERITA NEL
CASE BODY**



**CAVO ALIMENTAZIONE SCHEDA
APOLINK–VETRINA-ARMADI
VERTICALI PASTICCERIA GELATERIA**



**CAVO SERIALE SCHEDA APOLINK– VETRINA-
ARMADI VERTICALI PASTICCERIA
GELATERIA**



SUPPORTO PORTA RJ45

SUPPORTO PORTA RJ45



SUPPORTO PORTA RJ45



SUPPORTO CASE BODY VETRINA



SUPPORTO CASE BODY ABBATTITORI



CAVO SERIALE ABBATTITORI



CAVO ALIMENTAZIONE SCHEDA APOLINK ABBATTITORI



CAVO ETHERNET



PORTA RJ45



Operazioni per assemblare la scheda Apolink sulla gamma abbattitori – surgelatori rapidi di temperatura Blitz-Ultra e Flash-Chillstar

Spegnere la macchina

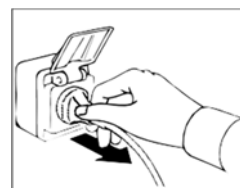
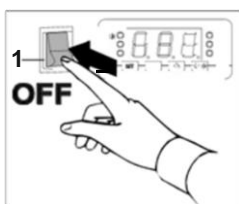

Modello 5 livelli

Rimuovere la griglia posteriore

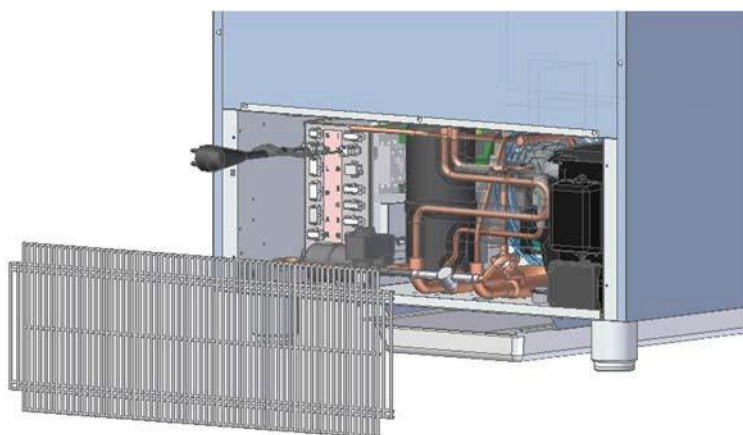

Prelevare il case body contenente la scheda Apolink



Prelevare il supporto del case body per gli abbattitori

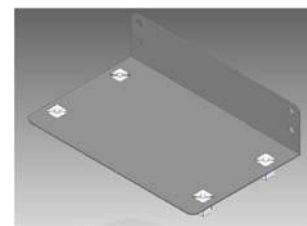

Assemblare il case body sul supporto

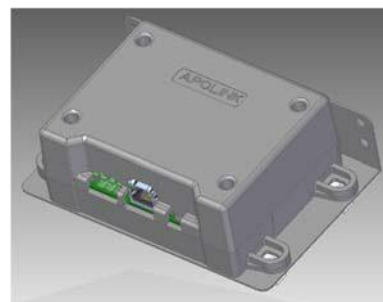

Assemblare gli inserti oteco sui fori presenti sul fondo esterno

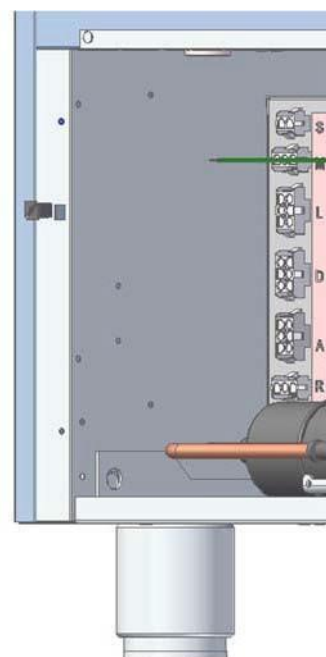
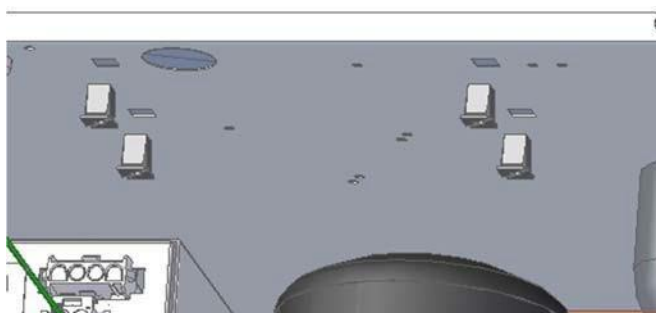

Prelevare i cavi muniti dei connettori mate-n-lok identificati con R ed S marcati con l'etichetta "Ultra/Flash/Blitz/Chillstar" e collegare al kit quadro e alla scheda Apolink. Collegare il cavo Ethernet alla porta RJ45 della scheda Apolink



Fissare il case body al fondo esterno mediante la viteria in dotazione

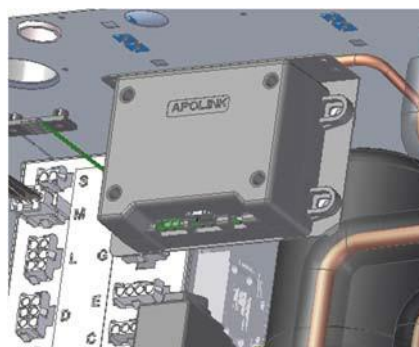

3449710

Prelevare il supporto ed assemblare la porta RJ45



Fissare il supporto RJ45 al vano motore nella zona posteriore

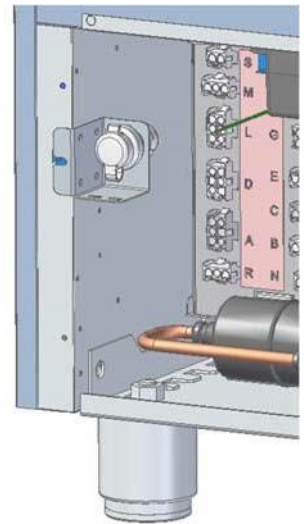

Collegare il cavo Ethernet alla porta RJ45

Rimontare la rete posteriore



Modello 10 livelli

Rimuovere il pannello superiore

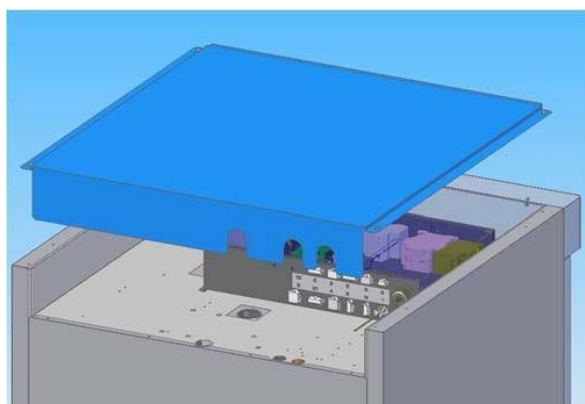

Prelevare il case body contenente la scheda Apolink



Assemblare gli inserti oteco sui fori presenti sul cielo esterno

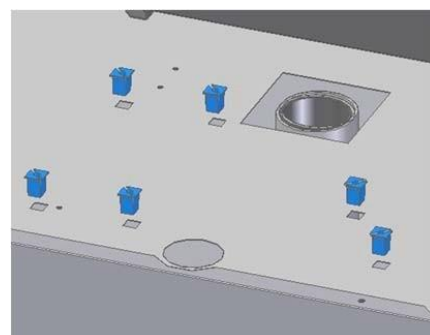

Fissare il case body al fondo esterno mediante la viteria in dotazione

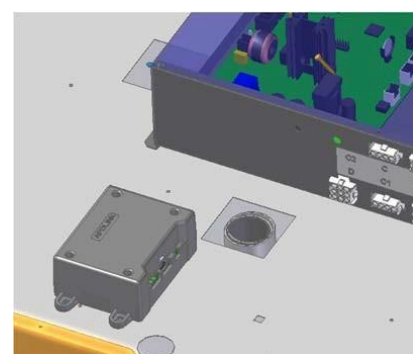

Prelevare i cavi muniti dei connettori mate-n-lok identificati con R ed S marcati con l'etichetta "Ultra/Flash Blitz/Chillstar e collegare al kit quadro e alla scheda Apolink. Collegare il cavo Ethernet alla porta RJ45 della scheda Apolink

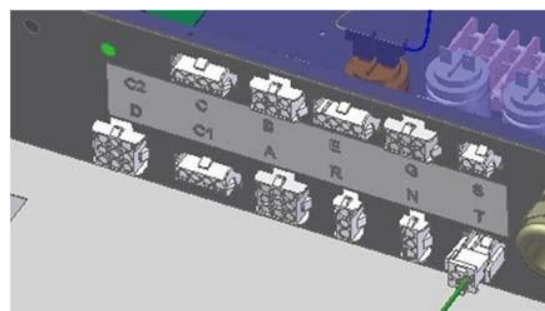

3449710

Prelevare il supporto ed assemblare la porta RJ45

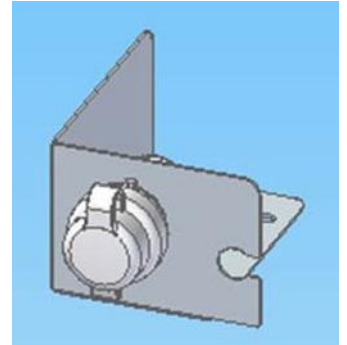

Fissare il supporto RJ45 al cielo superiore

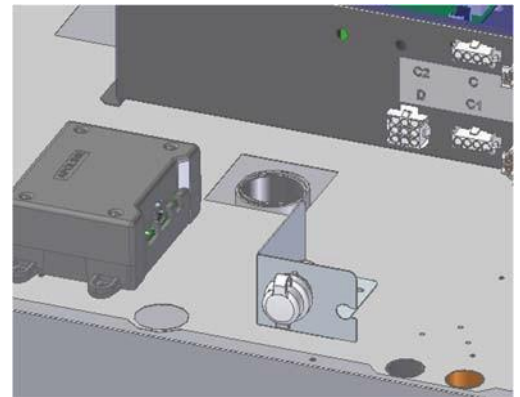

Collegare il cavo Ethernet alla porta RJ45

Rimontare il pannello superiore

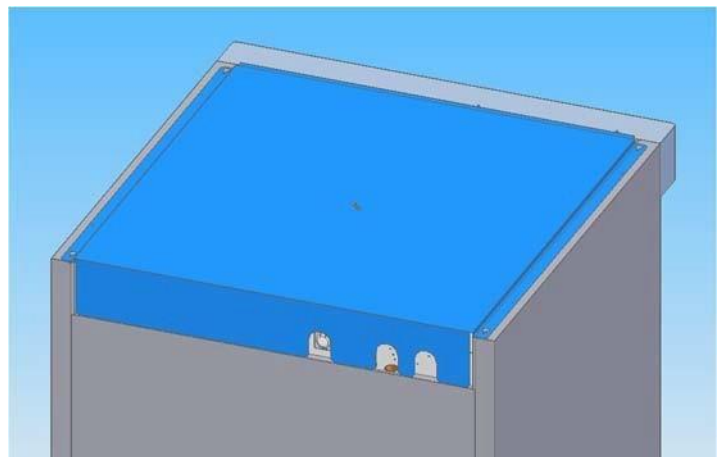

Modello sottoforno

Rimuovere i pannelli laterali



Prelevare il case body contenente la scheda Apolink



Prelevare il supporto del case body per gli abbattitori

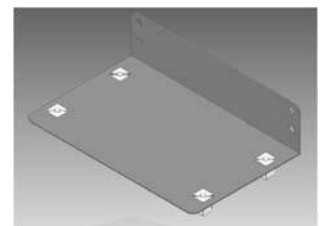

Assemblare il case body sul supporto



**Assemblare gli inserti oteco sui fori presenti
sul fianco del vano motore**

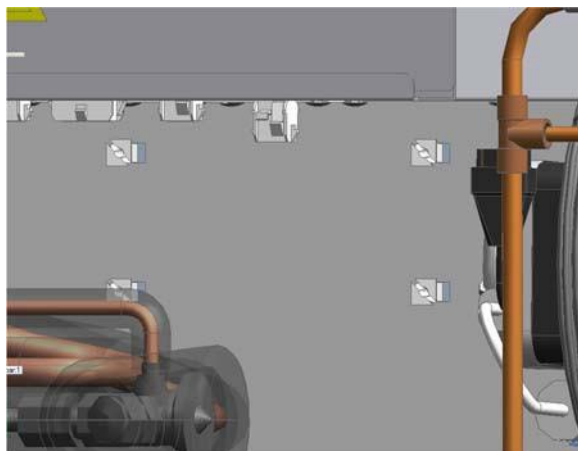

e sul fondo esterno

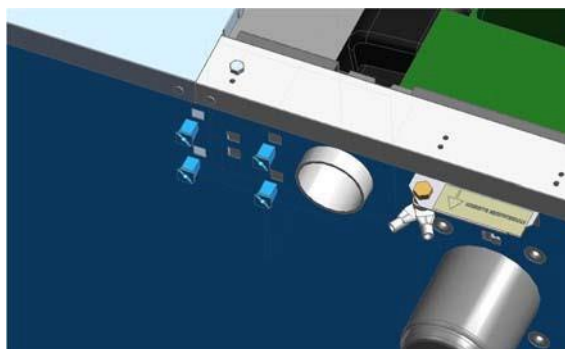

**Prelevare i cavi muniti dei
connettori mate-n-lok identificati
con R ed S, marcati “Ultra/Flash
Blitz/Chillstar” e collegare al kit
quadro e alla scheda Apolink.
Collegare il cavo Ethernet alla
porta RJ45 della scheda Apolink**

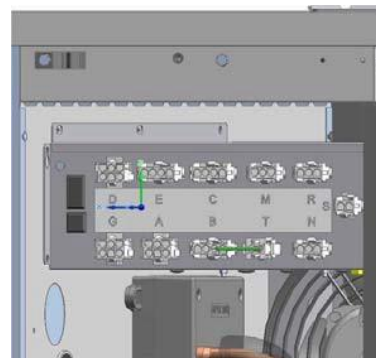

**Fissare il case body al fianco del vano
motore mediante la viteria in
dotazione**

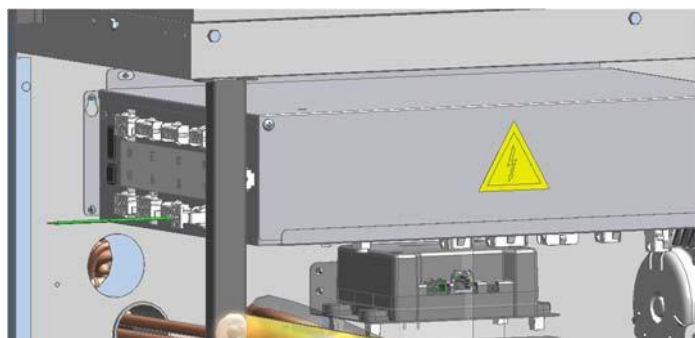

Prelevare il supporto ed assemblare la porta RJ45

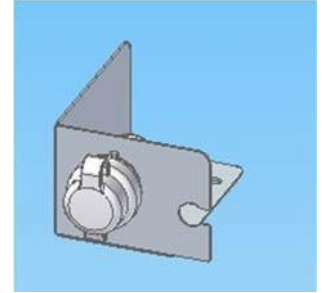

Fissare il supporto RJ45 al fondo esterno

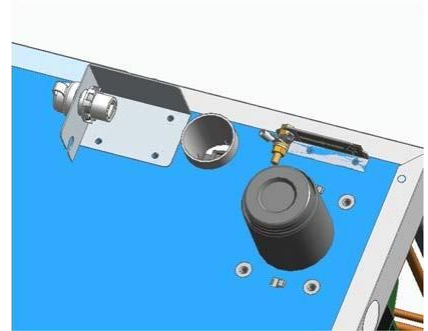

Collegare il cavo ethernet alla porta RJ45

Rimontare i pannelli laterali



Modello 20 teglie 11

Prelevare il case body contenente la scheda Apolink



Assemblare gli inserti oteco sui fori presenti sul cielo esterno

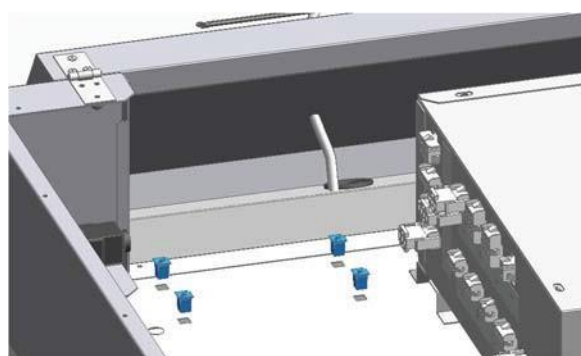
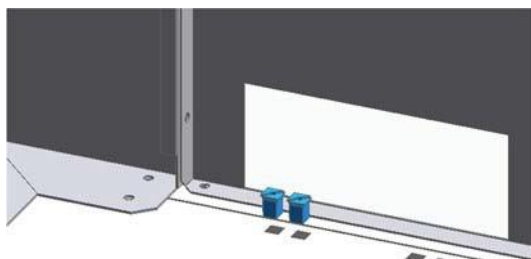

Fissare il case body al cielo esterno mediante la viteria in dotazione

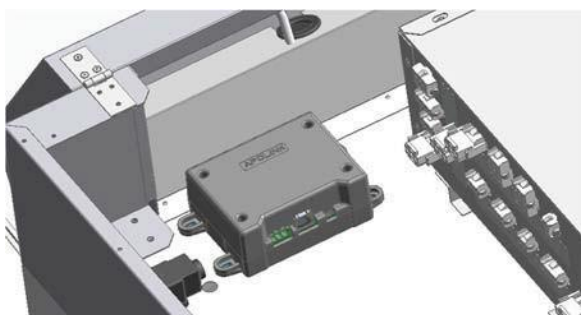

Prelevare i cavi muniti dei connettori mate-n-lok identificati con R ed S, e collegare al kit quadro e alla scheda Apolink.

Collegare il cavo Ethernet alla porta RJ45 della scheda Apolink

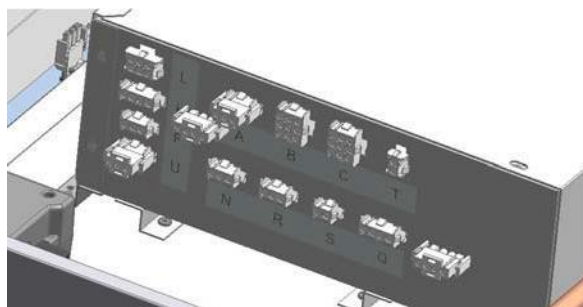

3449710



Prelevare il supporto ed assemblare la porta RJ45

Fissare il supporto RJ5 al fondo inferiore

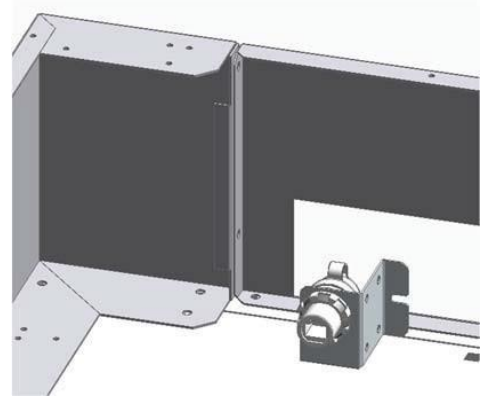

Collegare il cavo ethernet alla porta RJ45

Modello 20 teglie 21

Prelevare il case body contenente la scheda Apolink



Assemblare gli inserti oteco sui fori presenti sul cielo esterno

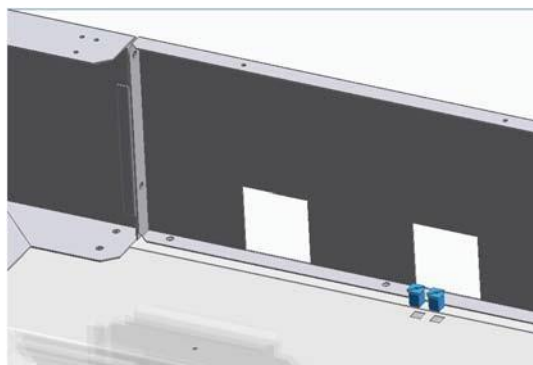

Fissare il case body al cielo esterno mediante la viteria in dotazione

Prelevare i cavi muniti dei connettori mate-n-lok identificati con R ed S, marcati "Ultra/Flash Blitz/Chillstar" e collegare al kit quadro e alla scheda Apolink. Collegare il cavo Ethernet alla porta RJ45 della scheda Apolink

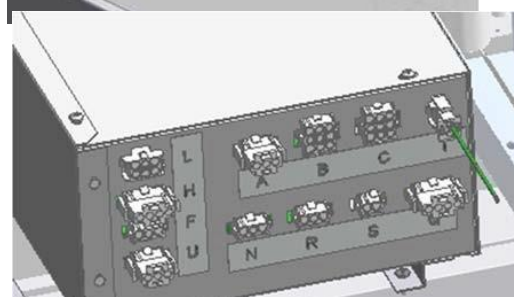
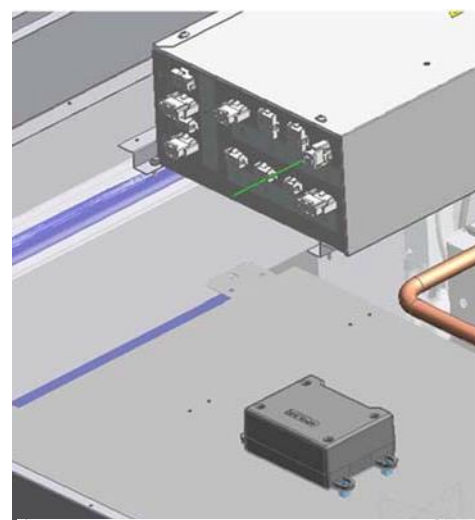

3449710

**Prelevare il supporto porta RJ45 ed
assemblare la porta RJ45**

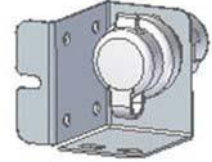

**Fissare il supporto RJ45 al cielo
superiore**

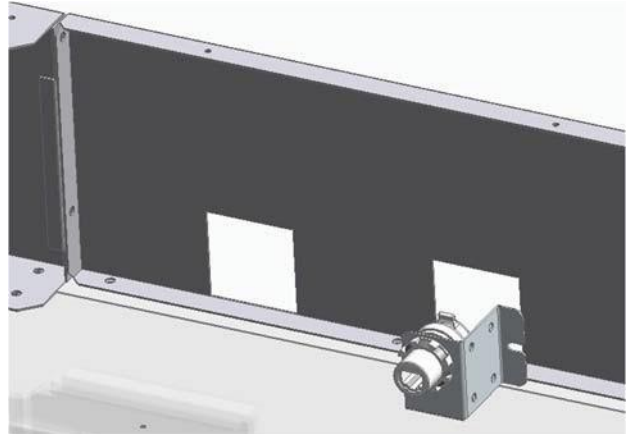

Collegare il cavo Ethernet alla porta RJ45

Accendere la macchina

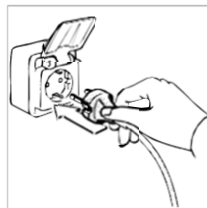

Operazioni per assemblare la scheda Apolink sulla gamma vetrine refrigerate New Style

Spegnere la macchina

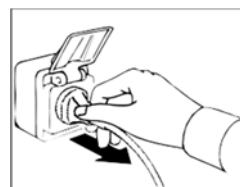
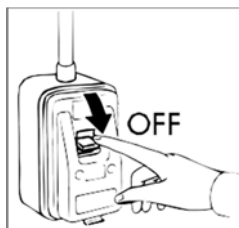
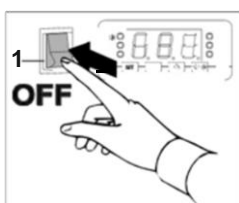

Rimuovere il fianco sinistro della vetrina

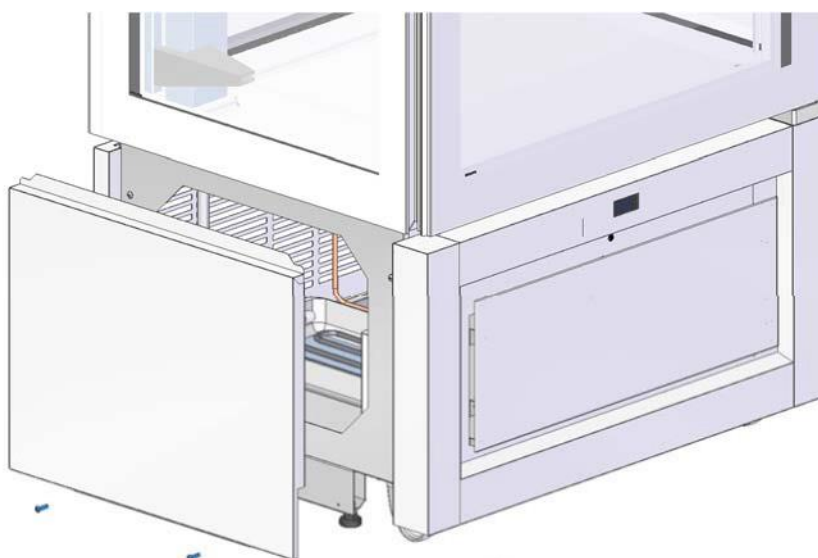

Prelevare il supporto case body vetrina

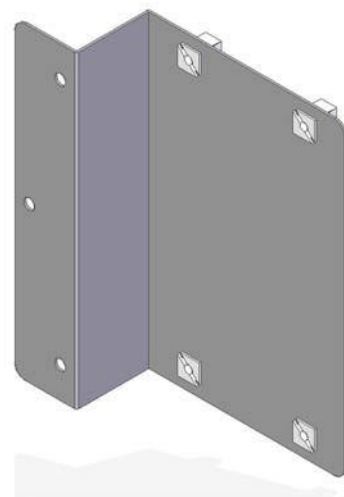

Fissare il supporto sul telaio della vetrina con la viteria in dotazione

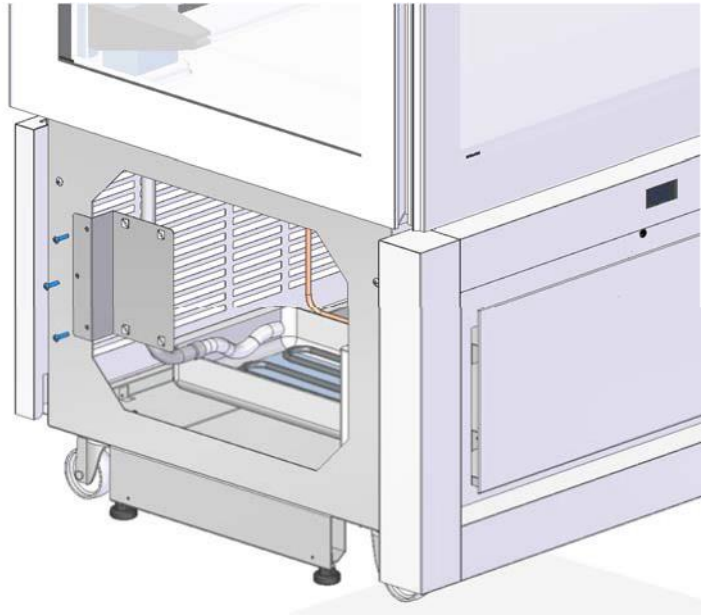

Prelevare il case body contenente la scheda Apolink



Fissare il case body al supporto mediante la viteria in dotazione

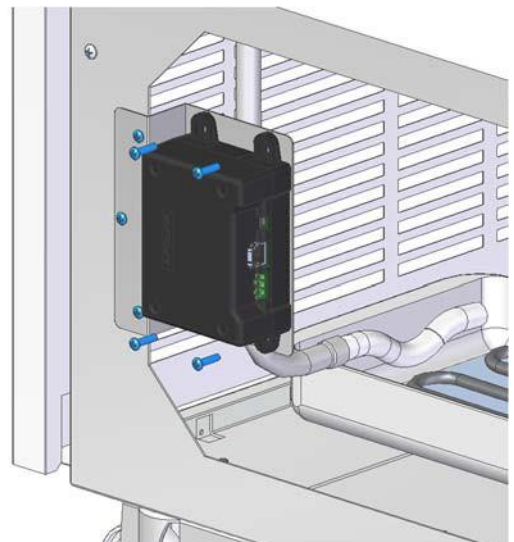

Prelevare i cavi muniti dei connettori mate-n-lok identificati con R ed S e collegare al kit quadro e alla scheda Apolink.

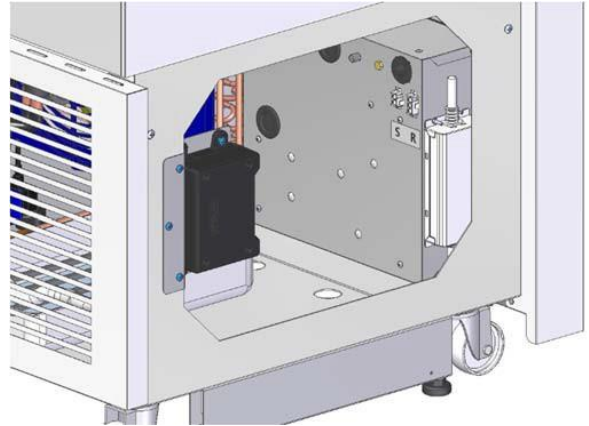

Prelevare il cavo Ethernet e collegarlo alla porta RJ45 della scheda Apolink

Rimontare il fianco sinistro

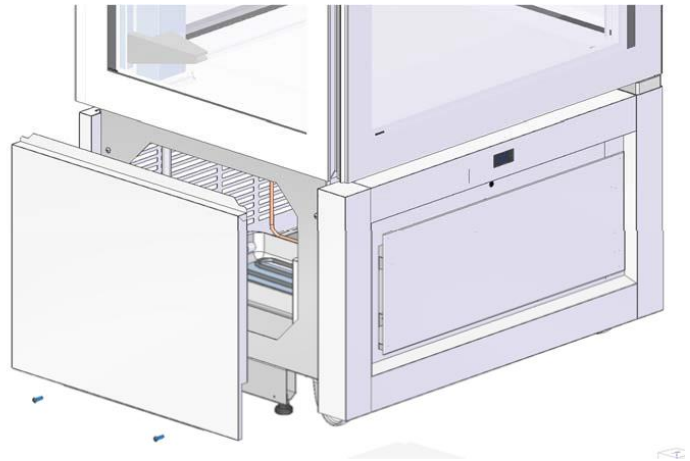

Accendere la macchina

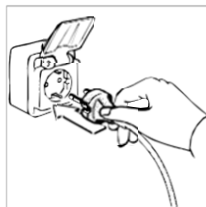

Operazioni per assemblare la scheda Apolink sulla gamma abbattitori – surgelatori multifunzione Ario - Now

Spegnere la macchina

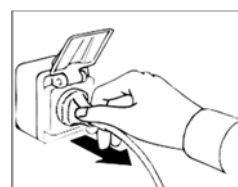
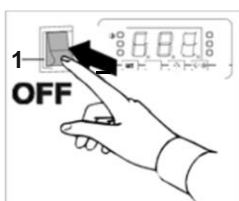

Modello 5 livelli

Rimuovere la griglia posteriore

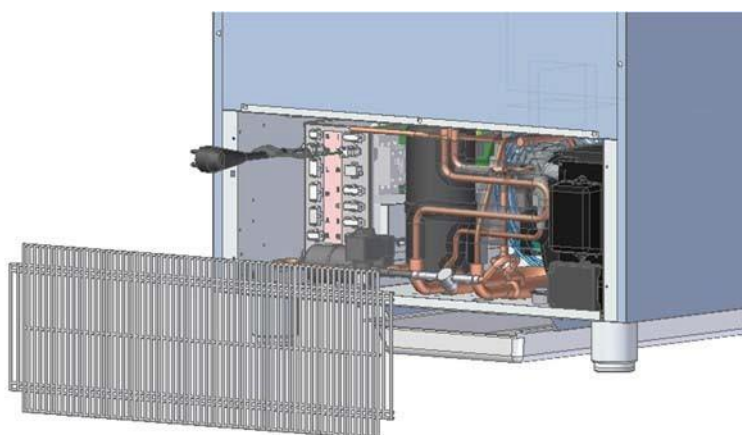

Prelevare il case body contenente la scheda Apolink



Assemblare gli inserti oteco sui fori presenti sul fondo esterno

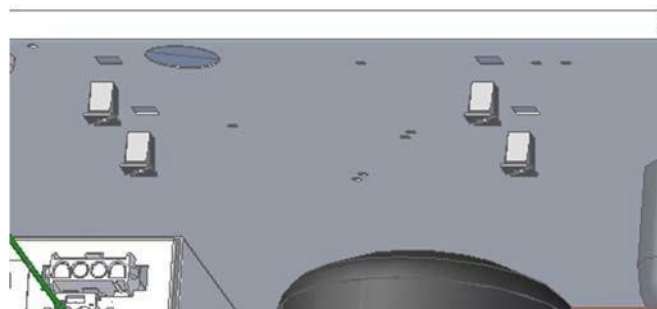

Prelevare i cavi muniti dei connettori mate-n-lok
 Identificati con R ed S e collegare al kit quadro ed alla
 scheda Apolink. **NON UTILIZZARE QUELLI SIGLATI
 PER BLITZ / ULTRA.** Collegare il cavo Ethernet alla
 porta RJ45 della scheda Apolink



Fissare il case body al fondo esterno mediante
 la viteria in dotazione

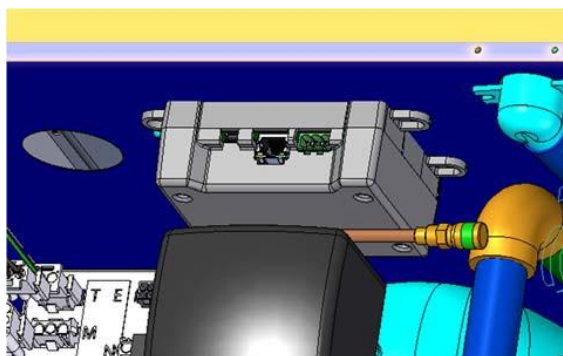

Prelevare il supporto ed assemblare la porta RJ45



Fissare il supporto RJ45 al basamento del motore

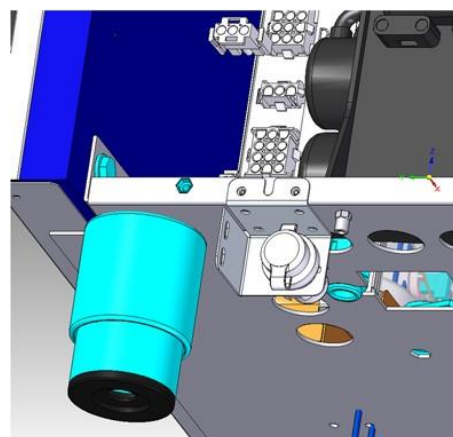

Collegare il cavo Ethernet alla porta RJ45

Rimontare la rete posteriore

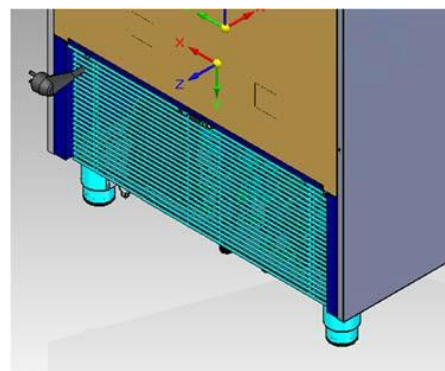

Modello 10 livelli

Rimuovere la griglia posteriore

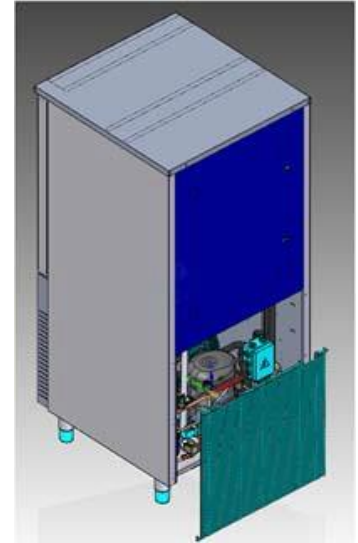

Prelevare il case body contenente la scheda Apolink



Assemblare gli inserti oteco sui fori presenti sul vano motore lato dx

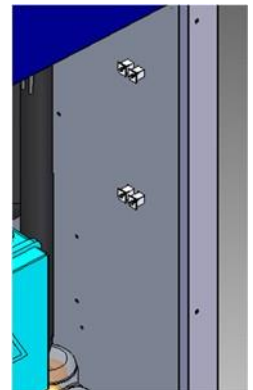

Fissare il case body al vano motore mediante la viteria in dotazione

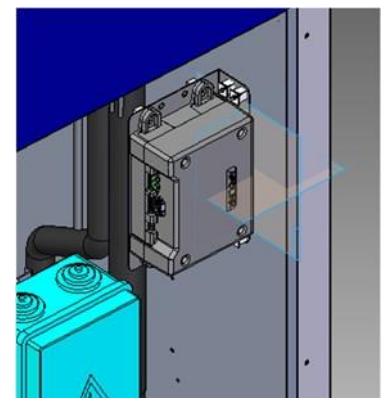

Prelevare i cavi muniti dei connettori mate-n-lok identificati con R ed S e collegare al kit quadro ed alla scheda Apolink. **NON UTILIZZARE QUELLI SIGLATI PER BLITZ / ULTRA.** Collegare il cavo Ethernet alla porta RJ45 della scheda Apolink

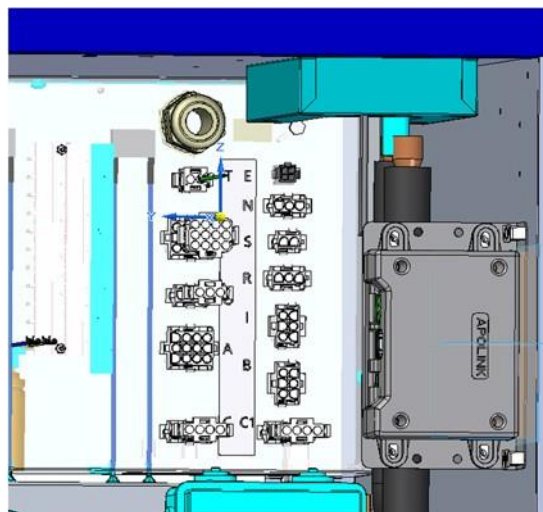

Prelevare il supporto ed assemblare la porta RJ45

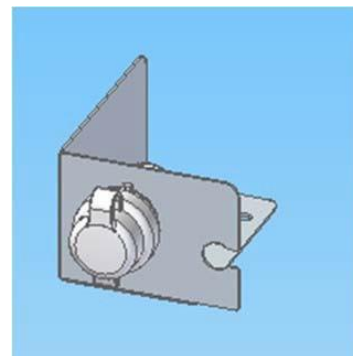

Fissare il supporto RJ45 al fondo esterno

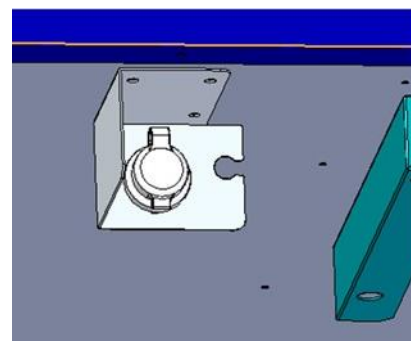

Collegare il cavo Ethernet alla porta RJ45

Rimontare la rete di protezione posteriore

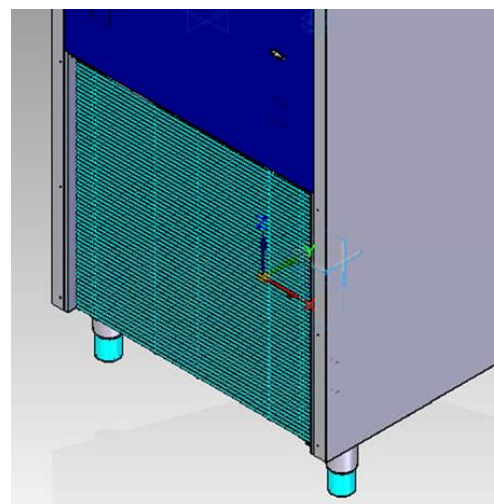

Modello sottoforno

Rimuovere i pannelli laterali

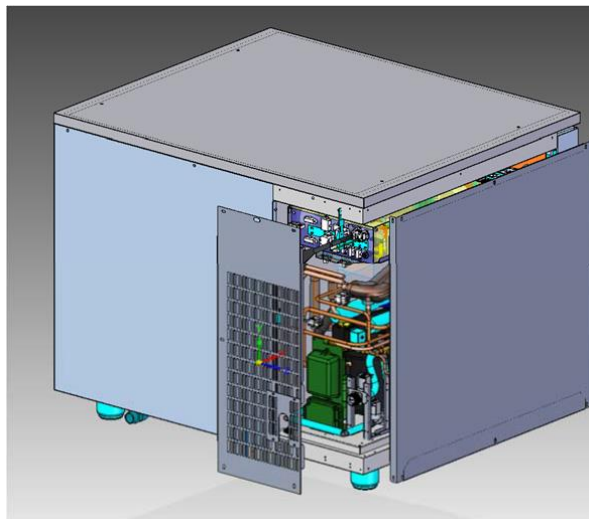

Prelevare il case body contenente la scheda Apolink



Prelevare il supporto del case body per gli abbattitori

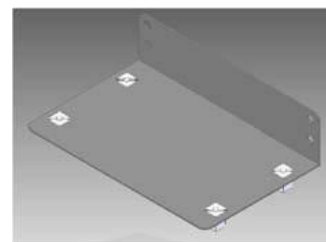

Assemblare il case body sul supporto



Assemblare gli inserti oteco sui fori presenti sul fianco del vano motore

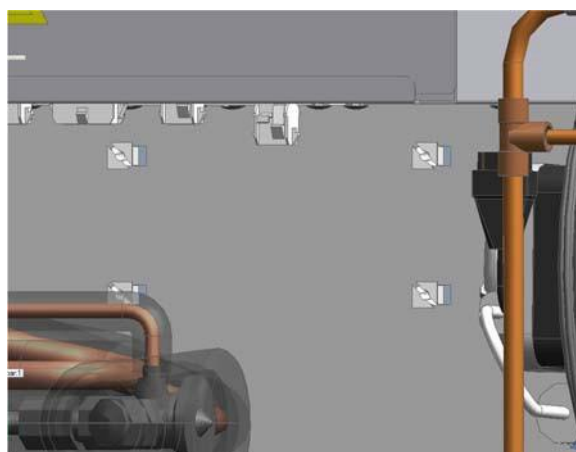

e sul fondo esterno

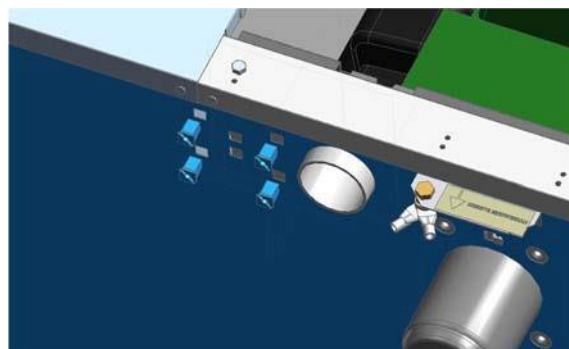

Prelevare i cavi muniti dei connettori mate-n-lok identificati con R ed S e collegare al kit quadro ed alla scheda Apolink. Collegare il cavo Ethernet alla porta RJ45 della scheda Apolink

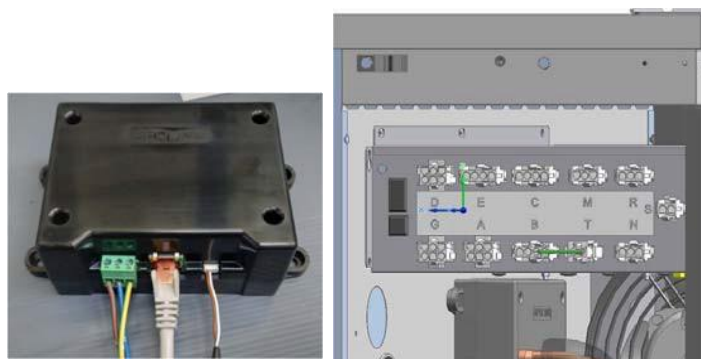

Fissare il case body al fianco del vano motore mediante la viteria in dotazione

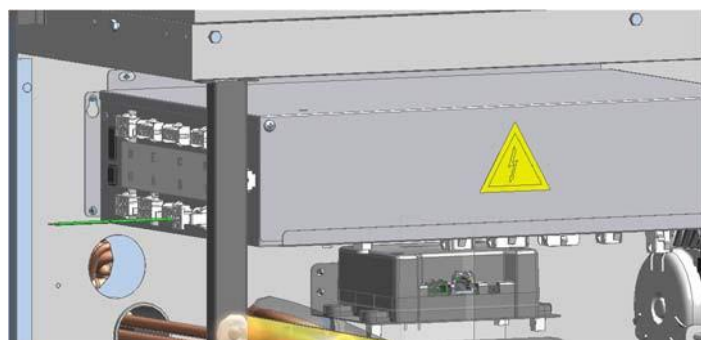

Prelevare il supporto ed assemblare la porta RJ45

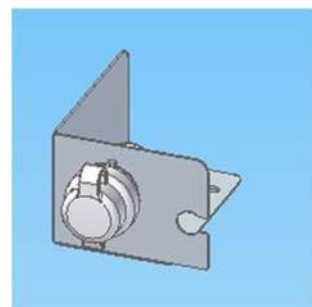

Fissare il supporto RJ45 al fondo esterno



3449710

Collegare il cavo ethernet alla porta RJ45

Rimontare i pannelli laterali



Accendere la macchina

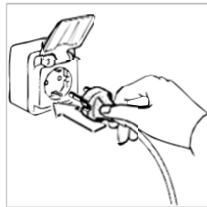

Operazioni per assemblare la scheda Apolink sulla gamma armadi frigoriferi Pasticceria e Gelateria

Spegnere la macchina

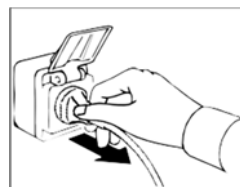
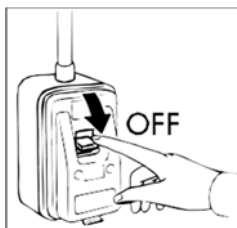
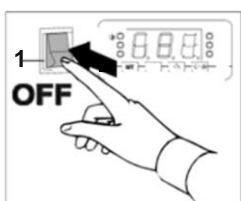

Modello armadio 6040

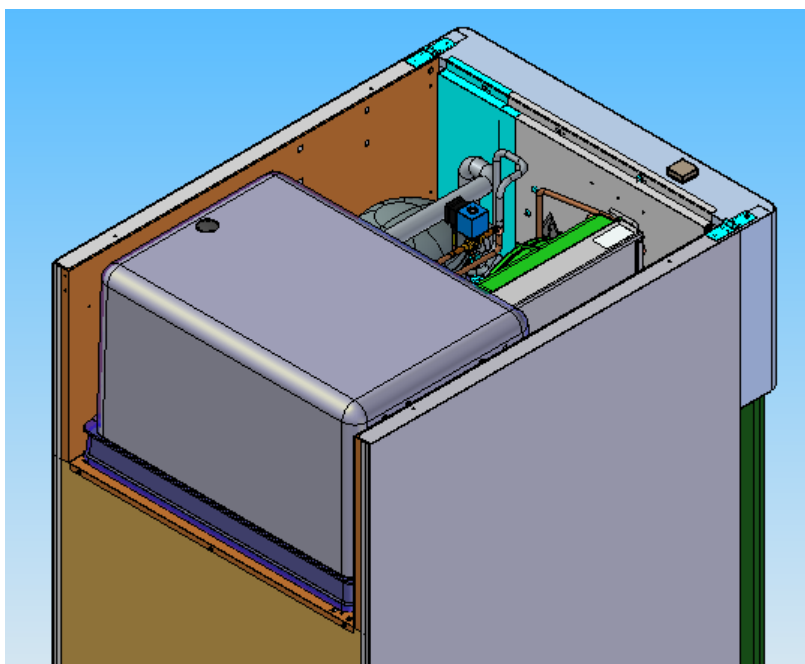

Prelevare il case body contenente la scheda Apolink



Assemblare gli inserti oteco sui fori presenti sul fianco del vano motore

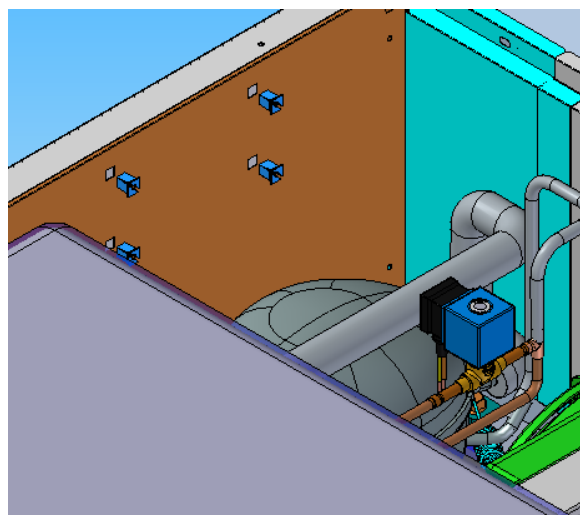

**Prelevare i cavi muniti dei connettori mate-n-lok
Identificati con R ed S e collegare al kit quadro ed
alla scheda Apolink. Collegare il cavo Ethernet alla
porta RJ45 della scheda Apolink**



**Fissare il case body al cielo esterno mediante la
viteria in dotazione**

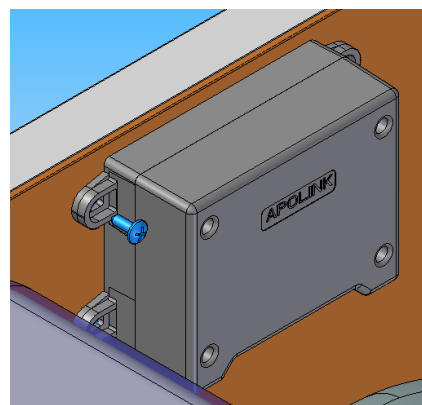

Prelevare il supporto ed assemblare la porta RJ45

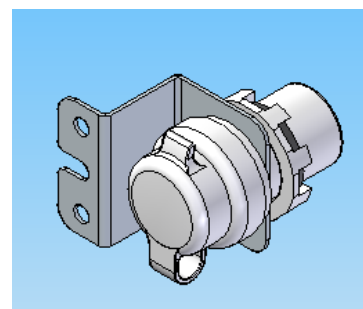

Fissare il supporto RJ45 al cielo esterno nella zona alta sinistra

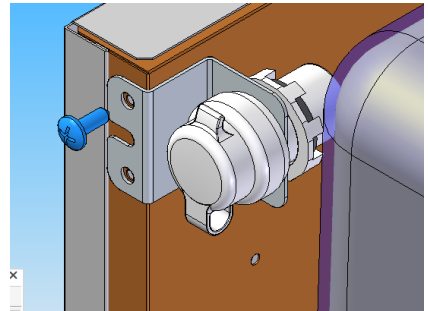

Collegare il cavo ethernet alla porta RJ45

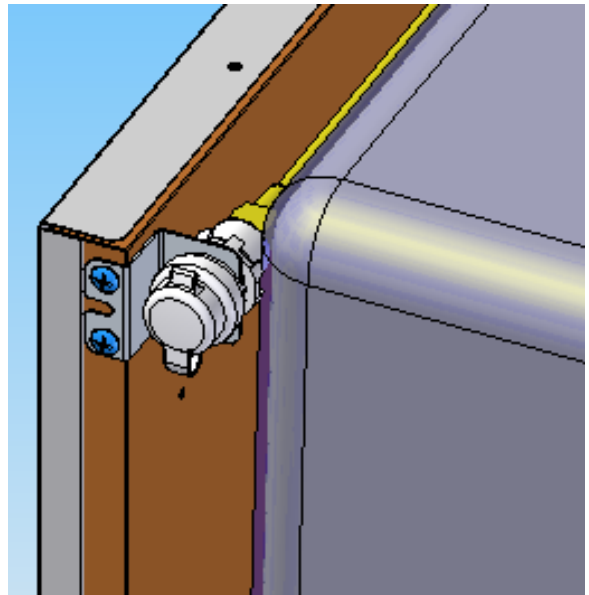

Modello armadio 6080

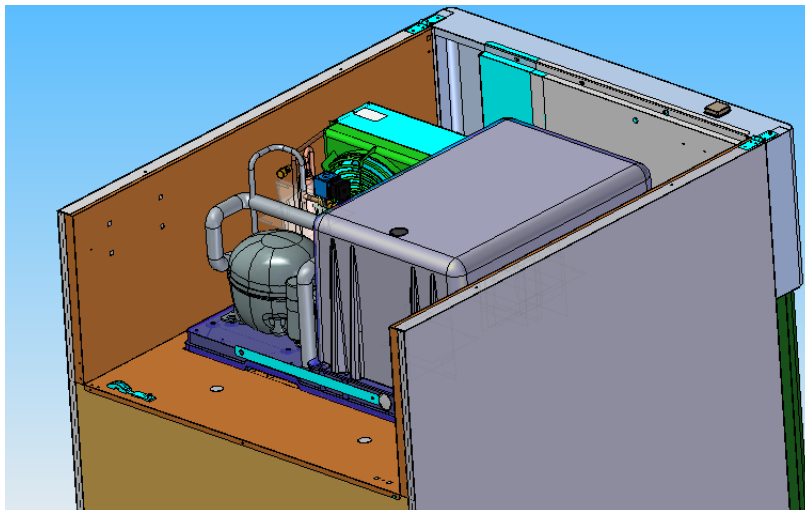

Prelevare il case body contenente la scheda Apolink



Assemblare gli inserti oteco sui fori presenti sul fianco del vano motore

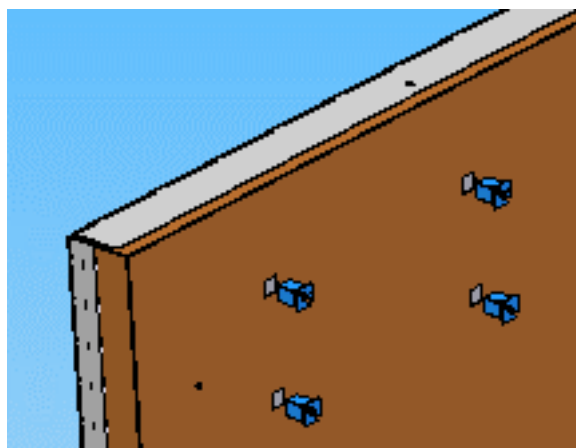

Prelevare i cavi muniti dei connettori mate-n-lok
Identificati con R ed S e collegare al kit quadro ed alla
scheda Apolink. Collegare il cavo Ethernet alla porta RJ45
della scheda Apolink



Fissare il case body al cielo esterno mediante la viteria in dotazione

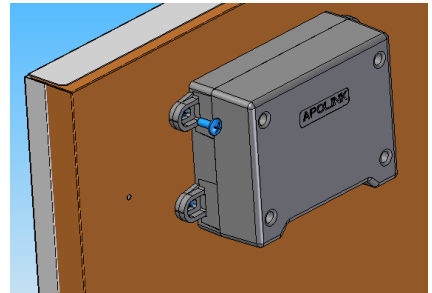

Prelevare il supporto ed assemblare la porta RJ45

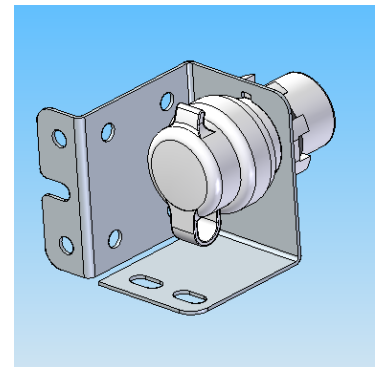

Fissare il supporto RJ45 al cielo esterno nella zona bassa sinistra

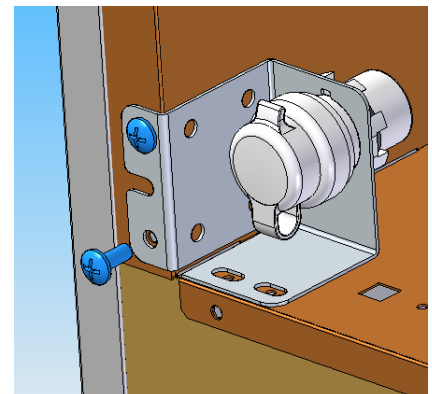

Collegare il cavo ethernet alla porta RJ45

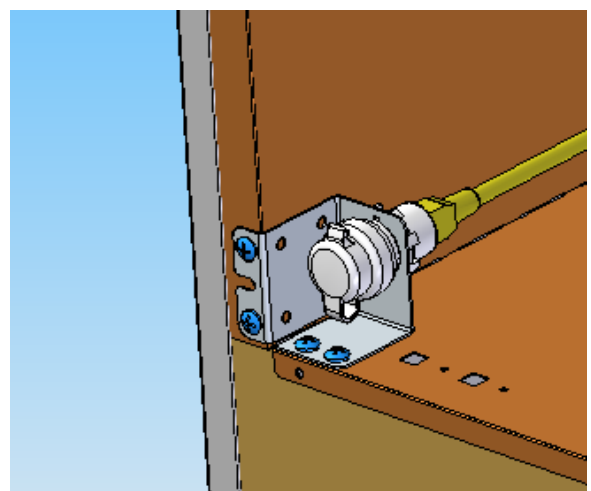

Modello armadio gelateria

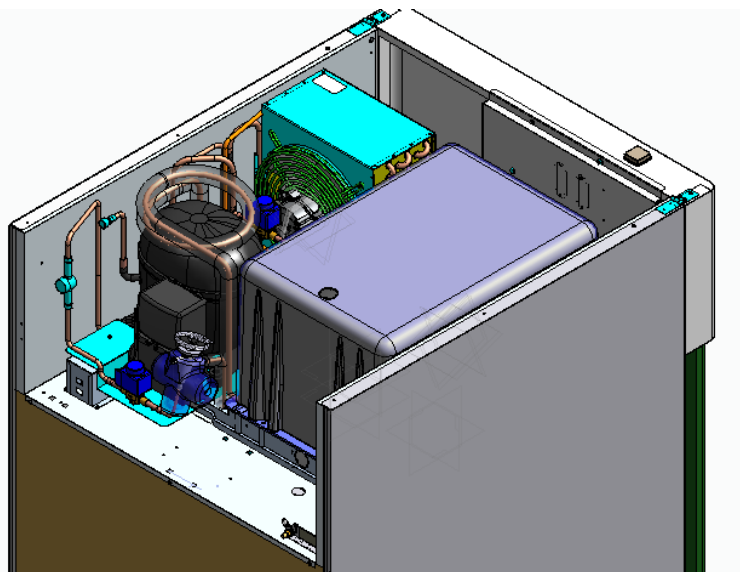

Prelevare il case body contenente la scheda APOLINK



Assemblare gli inserti oteco sui fori
presenti sul fianco del vano motore



Prelevare i cavi muniti dei connettori mate-n-lok
Identificati con R ed S e collegare al kit quadro ed alla
scheda Apolink. Collegare il cavo Ethernet alla porta RJ45
della scheda Apolink



Fissare il case body al cielo esterno mediante la viteria in dotazione

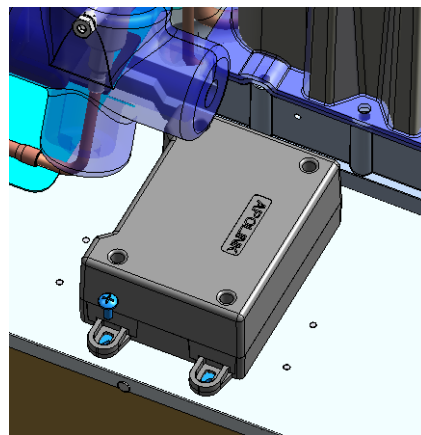

Prelevare il supporto ed assemblare la porta RJ45

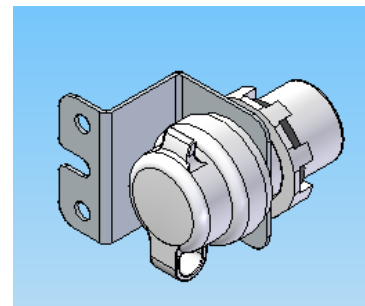

Fissare il supporto RJ45 al cielo esterno nella zona sinistra

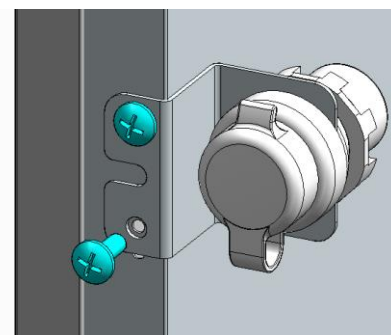

Collegare il cavo ethernet alla porta RJ45

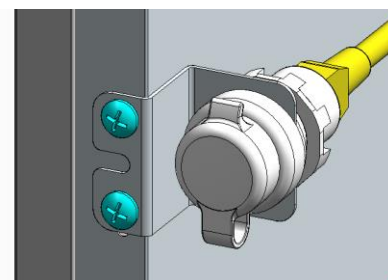

Accendere la macchina

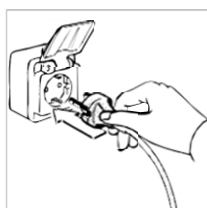

3449710

ACCESSORY



Accessory equipment

APOLINK CONTROL BOARD



APOLINK BOARD INSERTED IN THE CASE BODY



**APOLINK BOARD POWER CABLE—
PASTRY SHOP ICE CREAM
PARLOUR DISPLAY CASE-VERTICAL
DISPLAY CABINETS**



**APOLINK BOARD SERIAL CABLE—PASTRY
SHOP ICE CREAM PARLOUR DISPLAY CASE-
VERTICAL DISPLAY CABINETS**



RJ45 PORT HOLDER



RJ45 PORT HOLDER



RJ45 PORT HOLDER



DISPLAY CASE CASE BODY HOLDER



BLAST CHILLER CASE BODY HOLDER



BLAST CHILLER SERIAL CABLE



BLAST CHILLER APOLINK BOARD POWER CABLE



ETHERNET CABLE



RJ45 PORT



Operations for assembling the Apolink board on the Blitz-Ultra and Flash-Chillstar blast chiller – blast freezer range

Switch off the machine

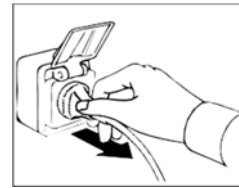
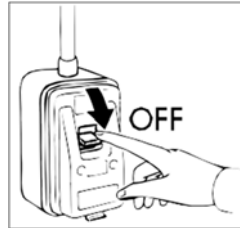
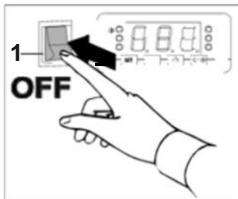

5 level model

Remove the rear grille

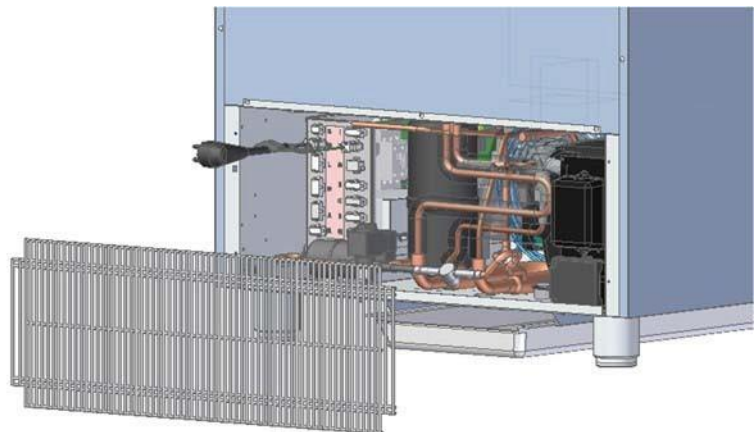

Take out the case body containing the Apolink board



Take out the body case holder for the blast chillers

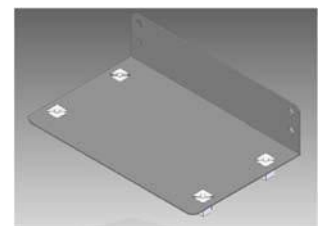

Assemble the case body on the holder



Assemble the Oteco inserts on the holes on the external bottom

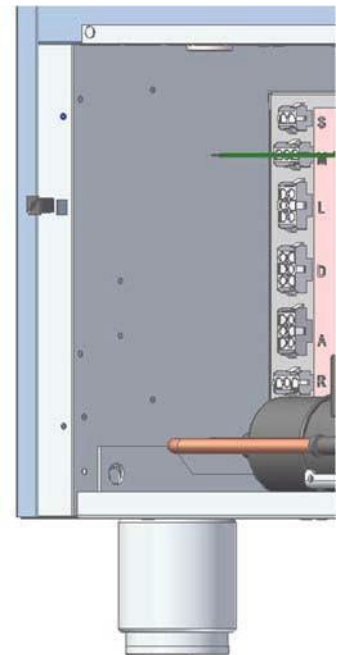
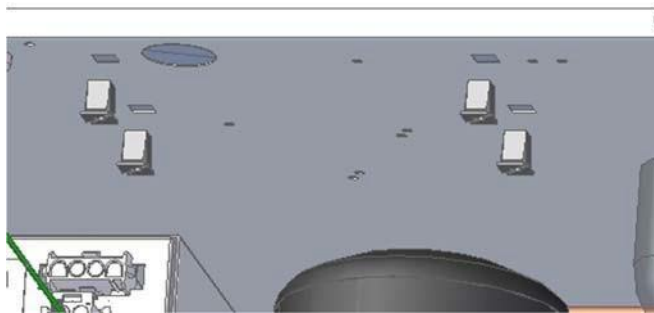

Take out the cables with the mate-n-lok connectors identified with R and S and connect them to the panel kit and Apolink board. Connect the Ethernet cable to the RJ45 port on the Apolink board



Fasten the case body to the external bottom using the supplied screws

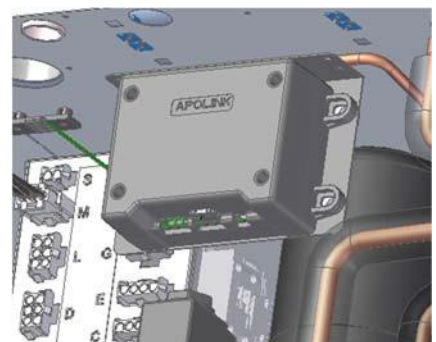

3449710

Take out the holder and assemble the RJ45 port



Fasten the RJ45 holder to the motor compartment in the rear area

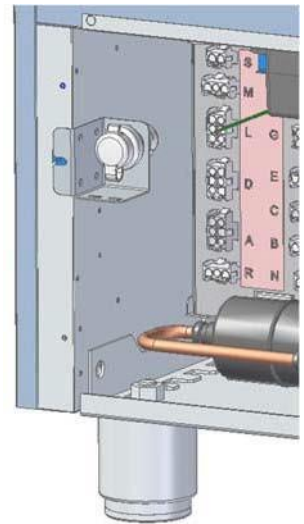

Connect the Ethernet cable to the RJ45 port

Reassemble the rear mesh



10 level model

Remove the top panel

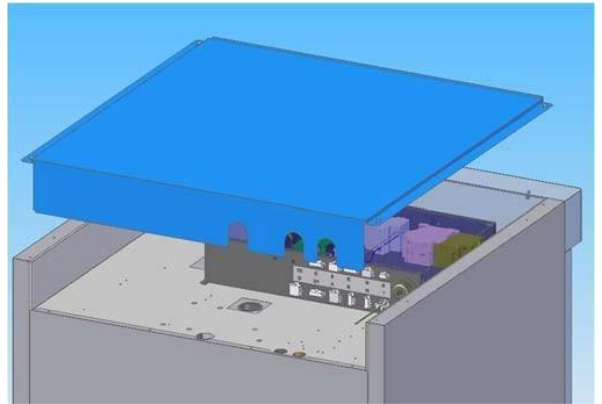

Take out the case body containing the Apolink board



Assemble the Oteco inserts to the holes in the external ceiling element

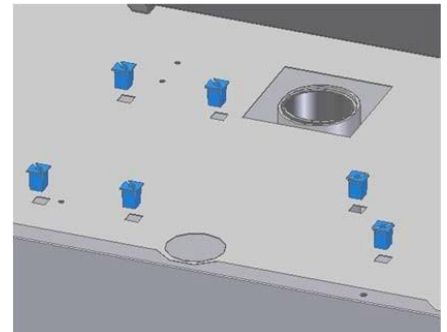

Fasten the case body to the external bottom using the supplied screws

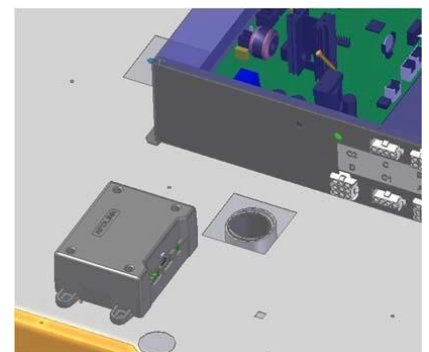

Take out the cables with the mate-n-lok connectors identified with R and S, marked with “Ultra/Flash Blitz/Chillstar” and connect them to the panel kit and Apolink board. Connect the Ethernet cable to the RJ45 port on the Apolink board.

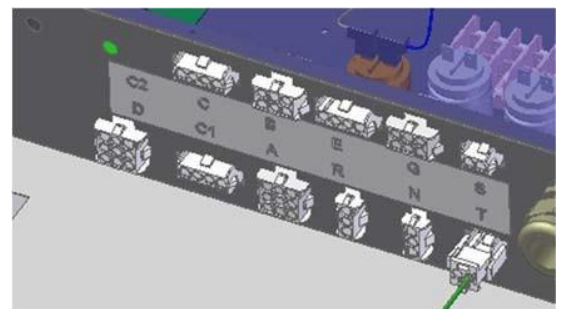

3449710

Take out the holder and assemble the RJ45 port

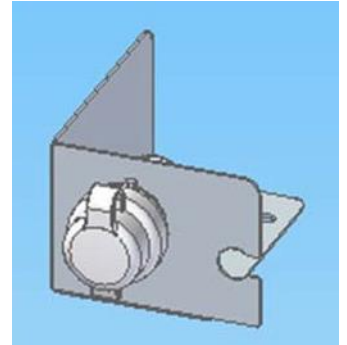

Fissare il supporto RJ45 al cielo superiore

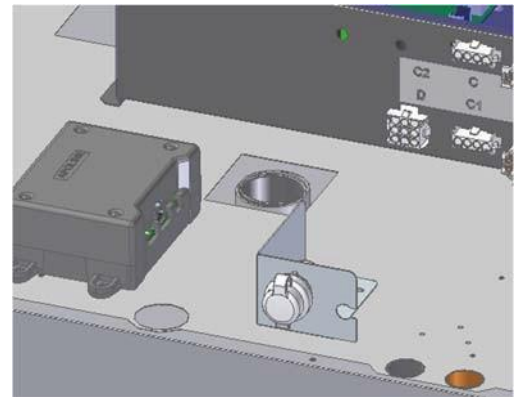

Connect the Ethernet cable to the RJ45 port

Reassemble the top panel

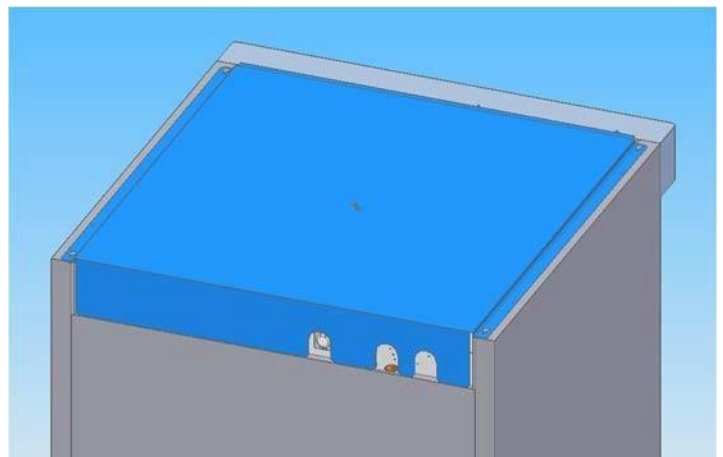

Under-oven model

Remove the side panels



Take out the case body containing the Apolink board



Take out the body case holder for the blast chillers

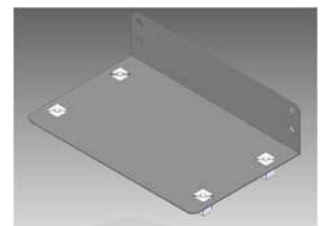

Assemble the case body on the holder



Assemble the Oteco inserts on the holes on the side of the motor compartment

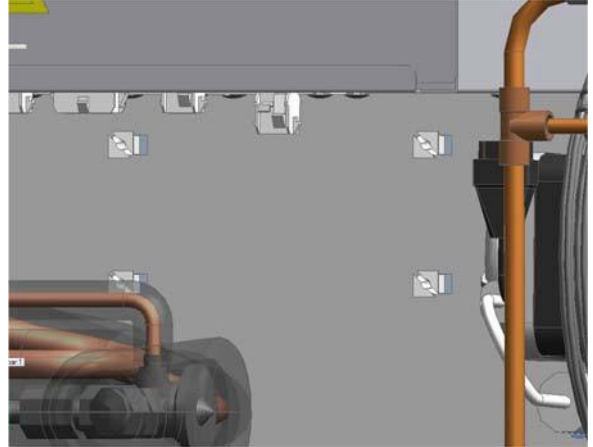

and on the external bottom

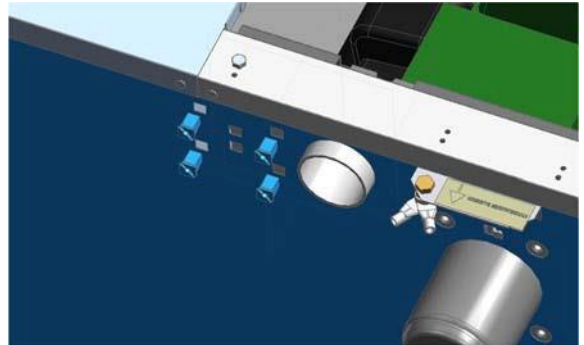

Take out the cables with the mate-n-lok connectors identified with R and S marked with “Ultra/Flash Blitz Chillstar” label and connect them to the panel kit and Apolink board. Connect the Ethernet cable to the RJ45 port on the Apolink board

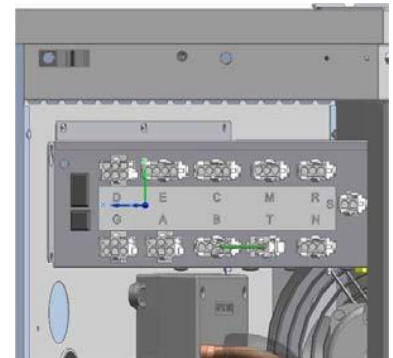

Fasten the case body to the side of the motor compartment using the supplied screws

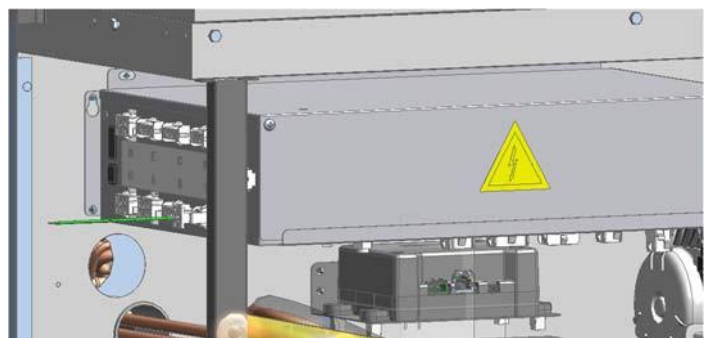

3449710

Take out the holder and assemble the RJ45 port

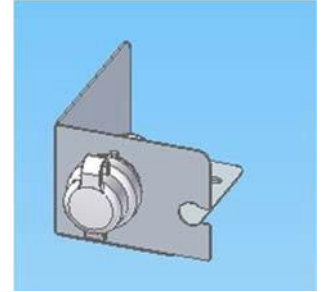

Fasten the RJ45 holder to the external bottom

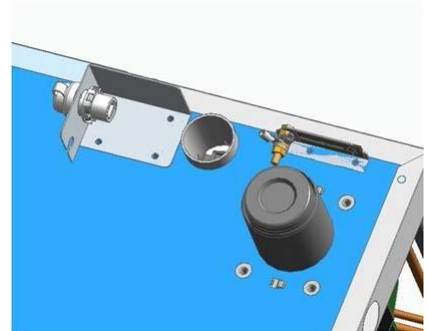

Connect the Ethernet cable to the RJ45 port

Remove the side panels



20 level model (1/1)

Take out the case body containing the Apolink board



Assemble the Oteco inserts to the holes in the external ceiling element

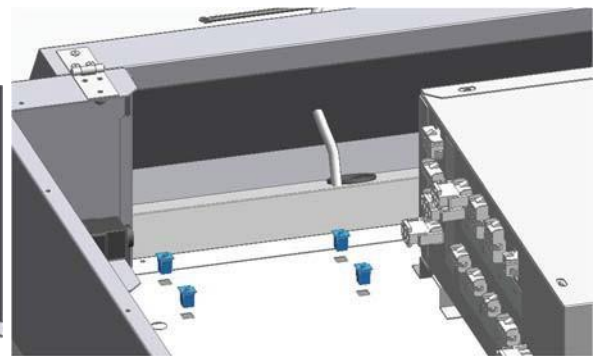
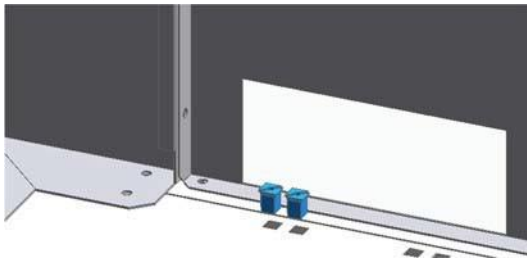

Fasten the case body to the external ceiling element using the supplied screws

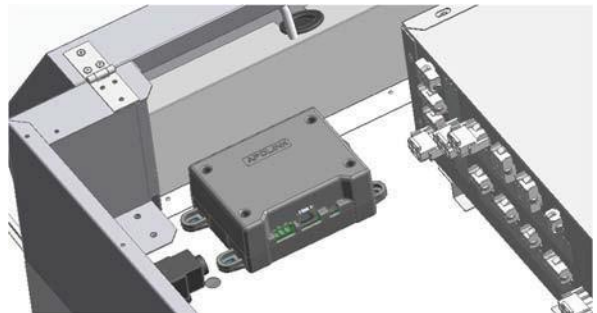

Take out the cables with the mate-n-lok connectors identified with R and S marked with "Ultra/Flash Blitz/Chillstar" and connect them to the panel kit and Apolink board. Connect the Ethernet cable to the RJ45 port on the Apolink board

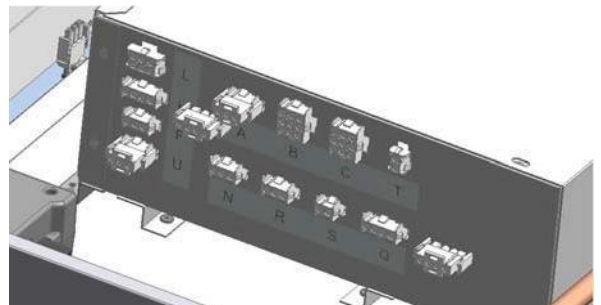

3449710

Take out the holder and assemble the RJ45 port



Fasten the RJ45 holder to the lower bottom

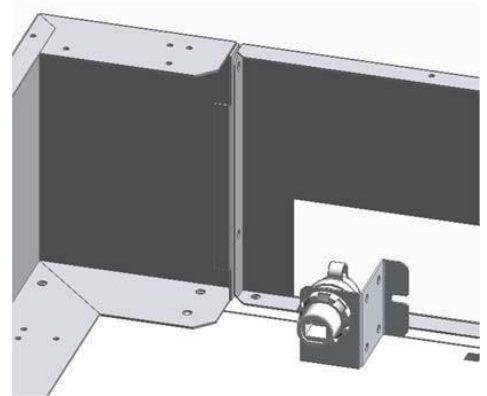

Connect the Ethernet cable to the RJ45 port

20 level model (2/1)

Take out the case body containing the Apolink board



Assemble the Oteco inserts to the holes in the external ceiling element

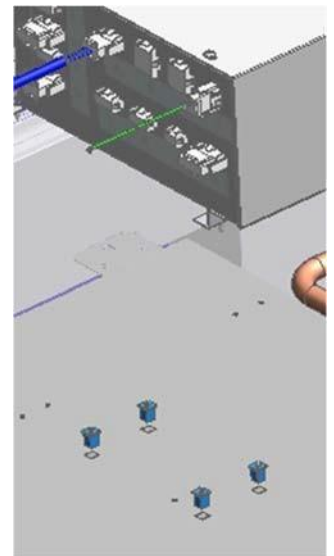
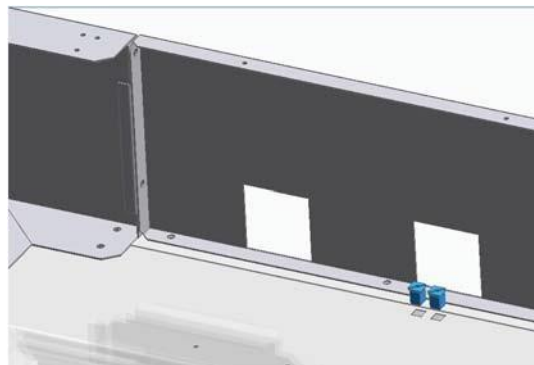

Fasten the case body to the external ceiling element using the supplied screws

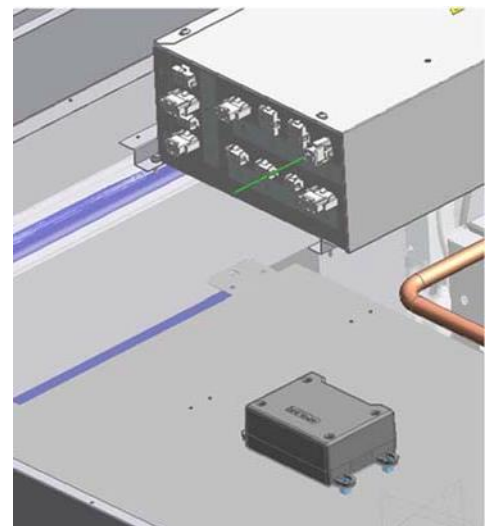

Take out the cables with the mate-n-lok connectors identified with R and S marked with "Ultra/Flash Blitz/Chillstar" label and connect them to the panel kit and Apolink board. Connect the Ethernet cable to the RJ45

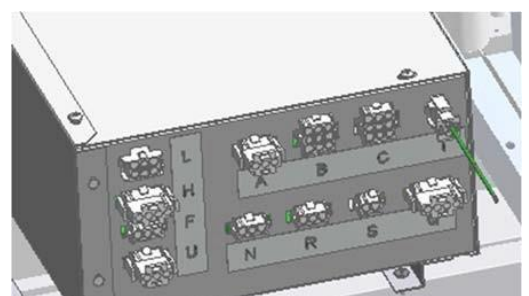

port on the Apolink board

Take out the RJ45 port holder and assemble the RJ45 port



Fasten the RJ45 holder to the top ceiling element

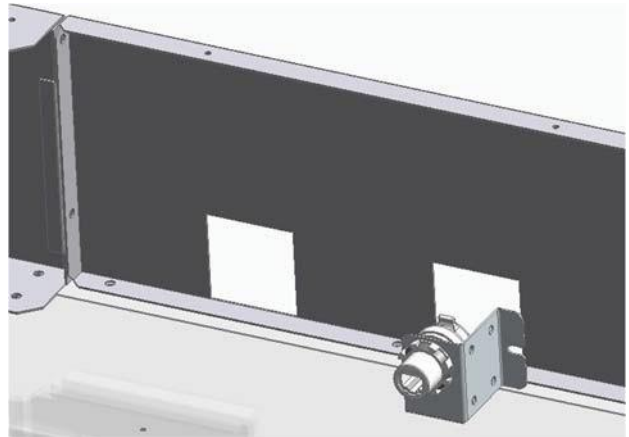

Connect the Ethernet cable to the RJ45 port

Switch on the machine

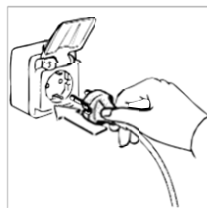

Operations for assembling the Apolink board on the New Style refrigerated display case range

Switch off the machine

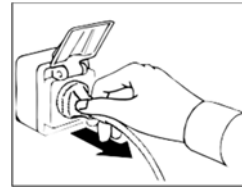
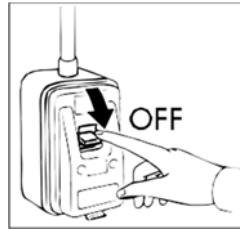
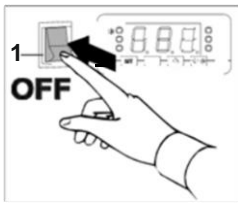

Remove the left side of the display case

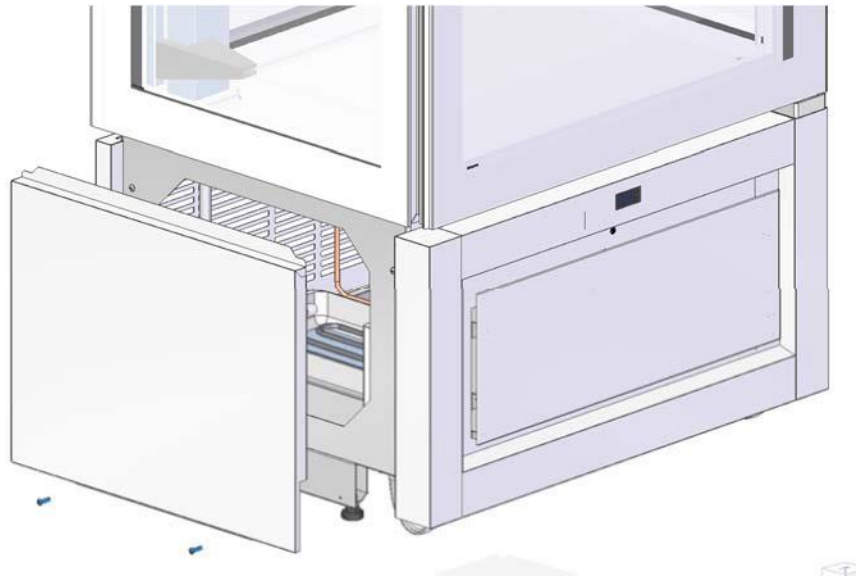

Take out the display case body holder

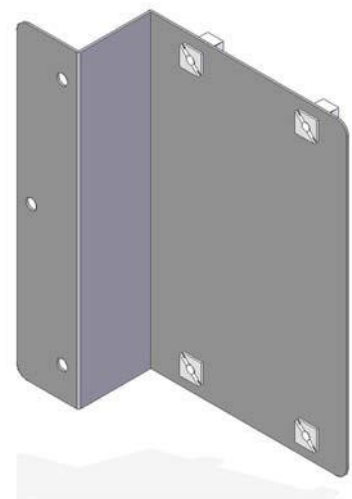

Fasten the holder on the display case frame with the supplied screws

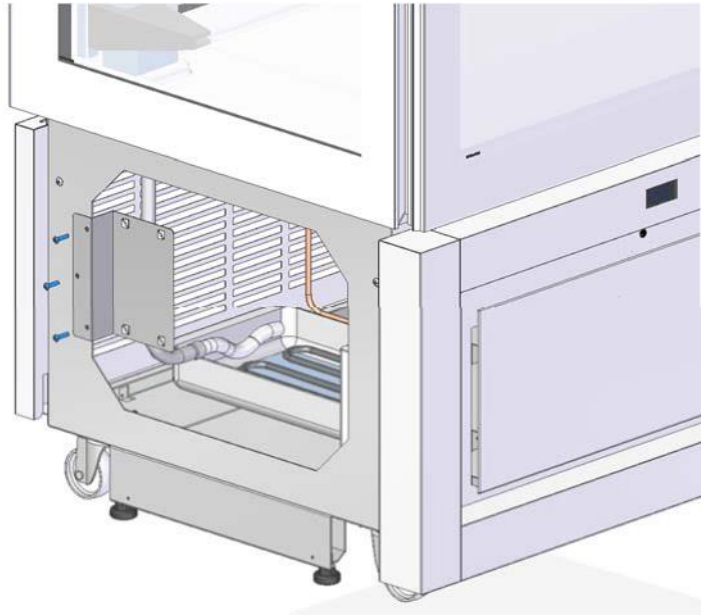

Take out the case body containing the Apolink board



Fasten the case body to the holder using the supplied screws

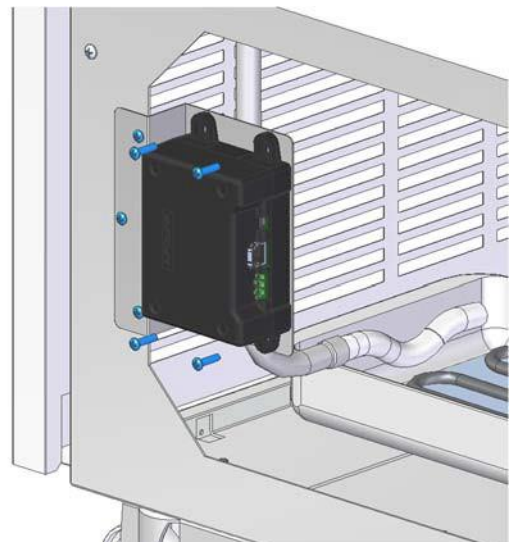

Take out the cables with the mate-n-lok connectors identified with R and S and connect them to the panel kit and Apolink board.

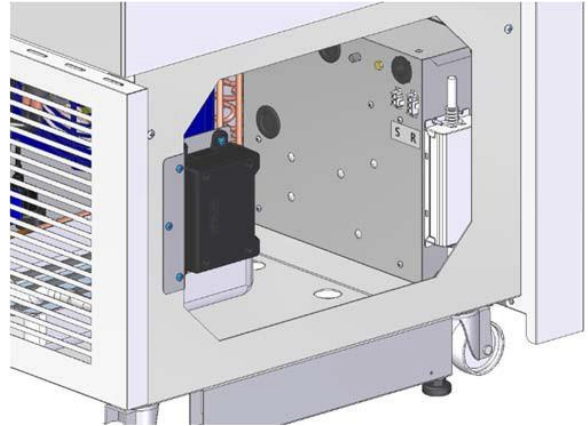

Take out the Ethernet cable and connect it to the RJ45 port on the Apolink board

Reassemble the left side panel

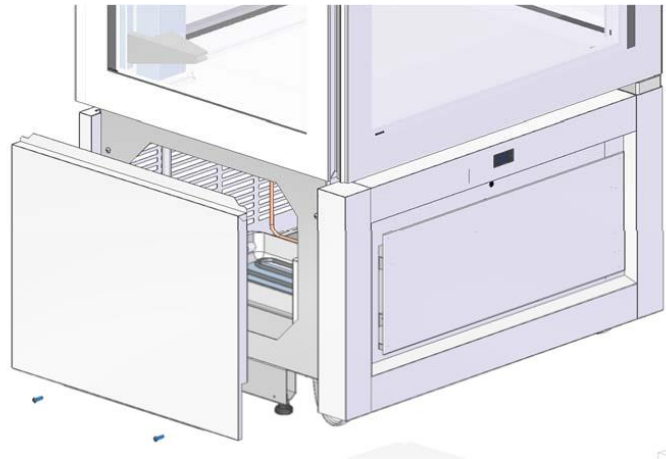

Switch on the machine

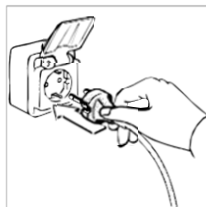

Operations for assembling the Apolink board on the multifunctional Ario - Now blast chiller – freezer range

Switch off the machine

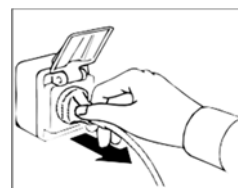
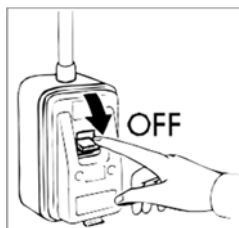
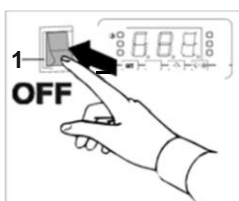

5 level model

Remove the rear grille

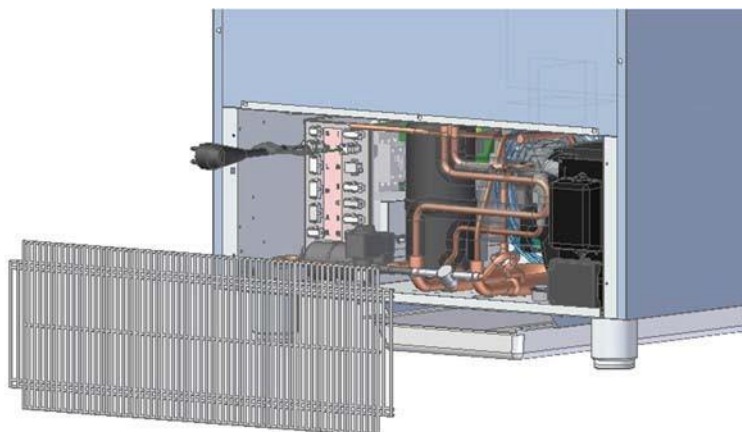

Take out the case body containing the Apolink board



Assemble the Oteco inserts on the holes on the external bottom

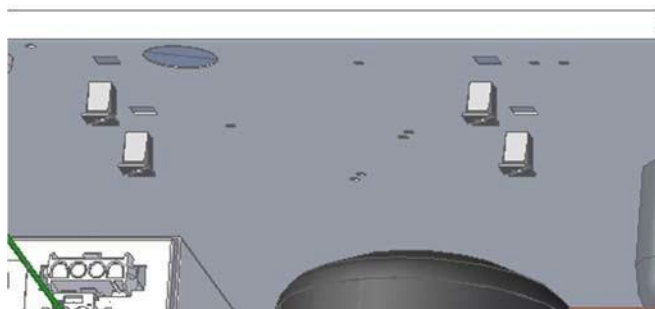

Take out the cables with the mate-n-lok connectors identified with R and S and connect them to the panel kit and Apolink board. **DO NOT USE THOSE MARKED FOR BLITZ / ULTRA.** Connect the Ethernet cable to the RJ45 port on the Apolink board



Fasten the case body to the external bottom using the supplied screws

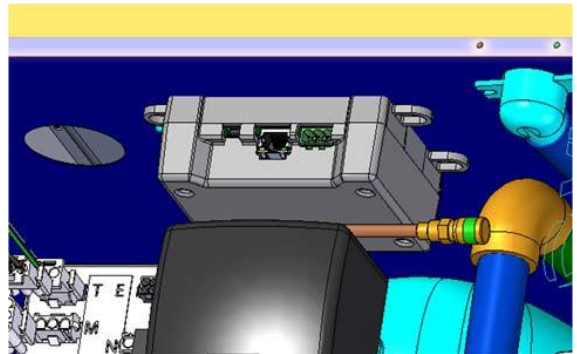

Take out the holder and assemble the RJ45 port



Fasten the RJ45 holder to the motor base

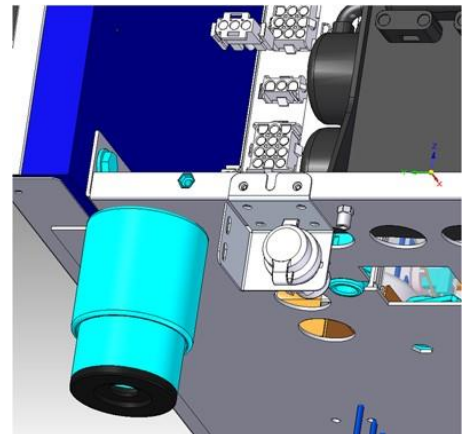

Connect the Ethernet cable to the RJ45 port

Reassemble the rear mesh

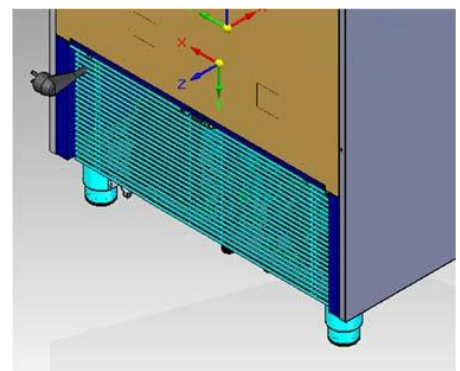

10 level model

Remove the rear grille

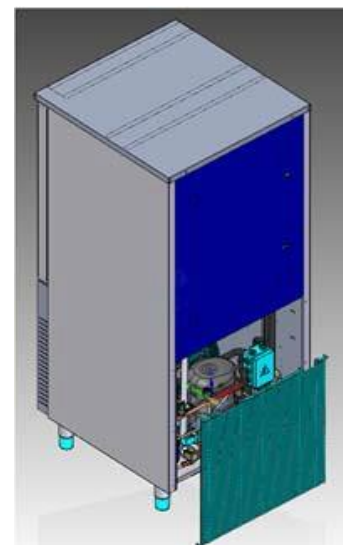

Take out the case body containing the Apolink board



Assemble the Oteco inserts on the holes on the right side of the motor compartment

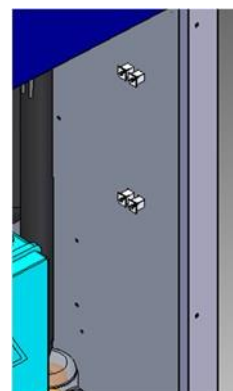

Fasten the case body to the motor compartment using the supplied screws

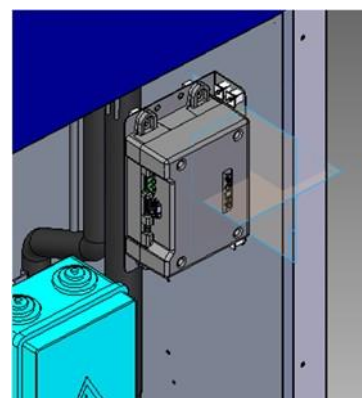

Take out the cables with the mate-n-lok connectors identified with R and S and connect them to the panel kit and Apolink board. **DO NOT USE THOSE MARKED FOR BLITZ / ULTRA.**

Connect the Ethernet cable to the RJ45 port on the Apolink board

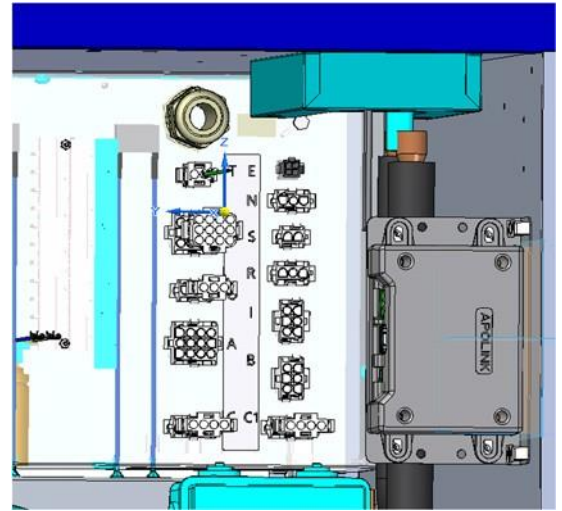

Take out the holder and assemble the RJ45 port

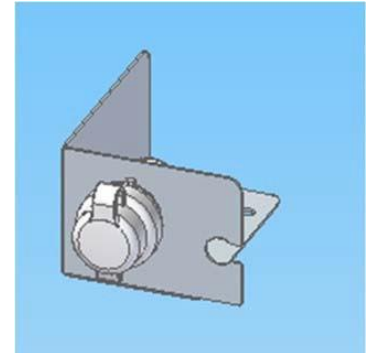

Fasten the RJ45 holder to the external bottom

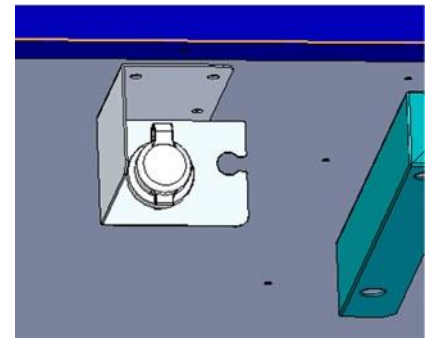

Connect the Ethernet cable to the RJ45 port

Reassemble the rear protective mesh

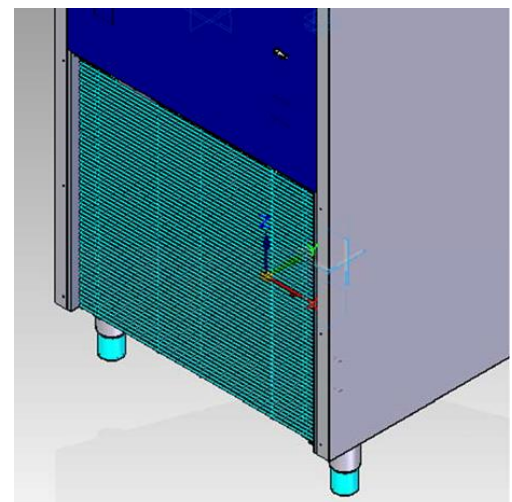

Under-oven model

Remove the side panels

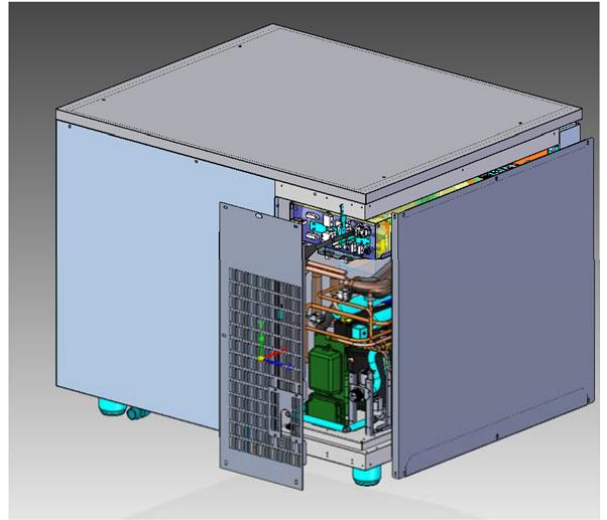

Take out the case body containing the Apolink board



Take out the body case holder for the blast chillers

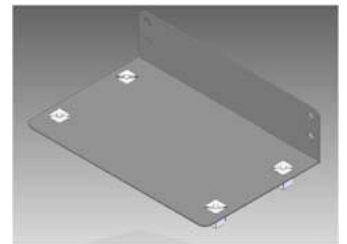

Assemble the case body on the holder



Assemble the Oteco inserts on the holes on the side of the motor compartment

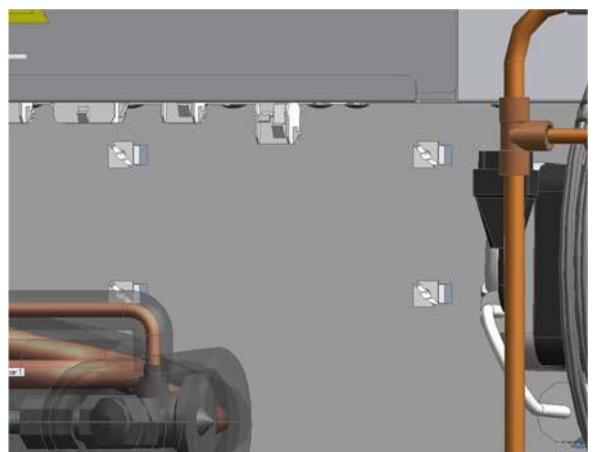

and on the external bottom

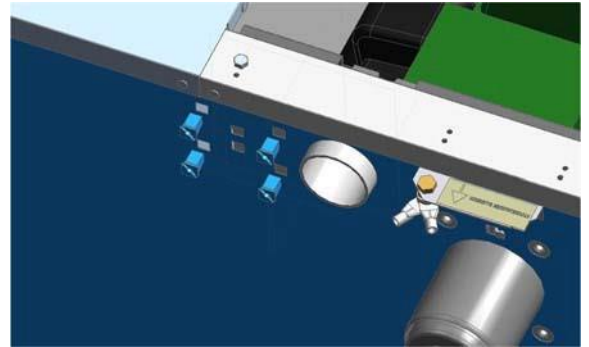

Take out the cables with the mate-n-lok connectors identified with R and S and connect them to the panel kit and Apolink board. Connect the Ethernet cable to the RJ45 port on the Apolink board

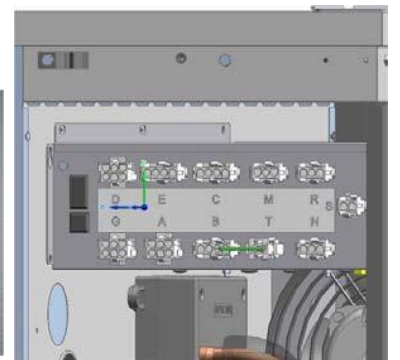

Fasten the case body to the side of the motor compartment using the supplied screws

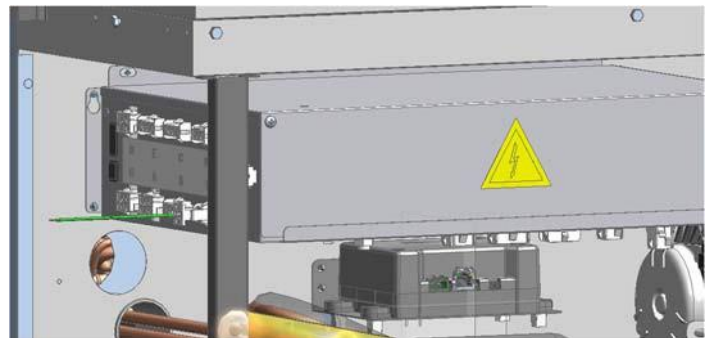

Take out the holder and assemble the RJ45 port

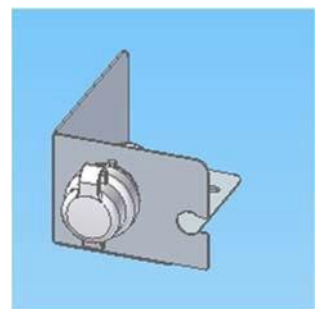

Fasten the RJ45 holder to the external bottom



3449710

Connect the Ethernet cable to the RJ45 port

Remove the side panels



Switch on the machine

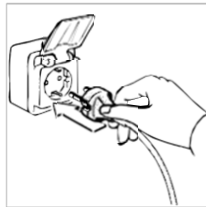

Operations for assembling the Apolink board on the Pastry Shop and Ice Cream Parlour refrigerator range

Switch off the machine

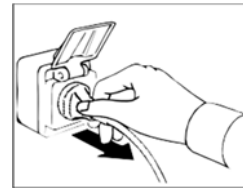
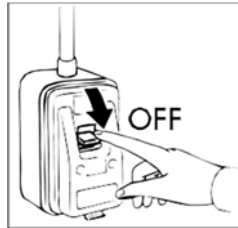
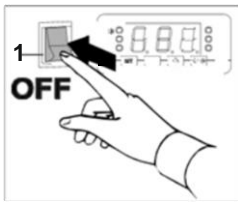

6040 cabinet model

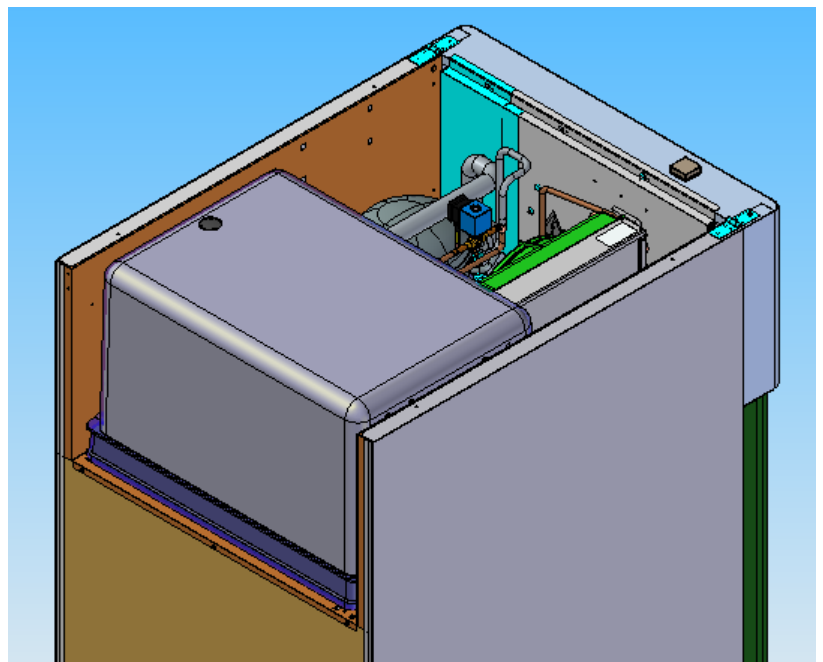

Take out the case body containing the Apolink board



Assemble the Oteco inserts on the holes on the side of the motor compartment

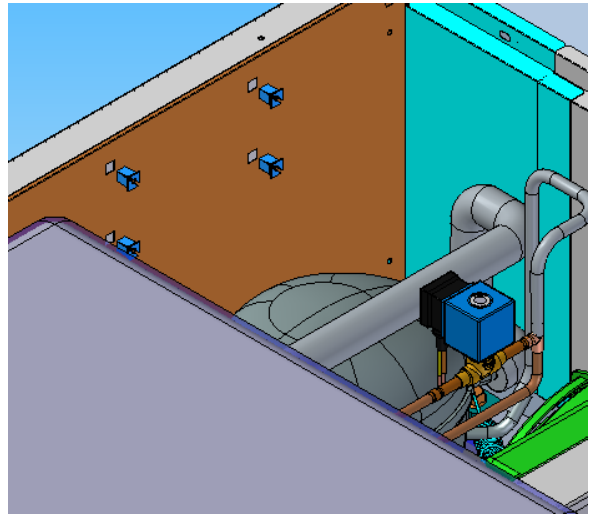

Take out the cables with the mate-n-lok connectors identified with R and S and connect them to the panel kit and Apolink board. Connect the Ethernet cable to the RJ45 port on the Apolink board



Fasten the case body to the external ceiling element using the supplied screws

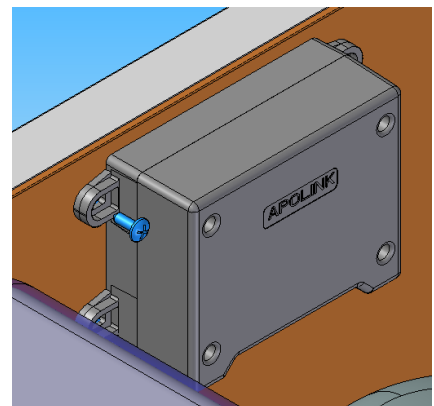

Take out the holder and assemble the RJ45 port

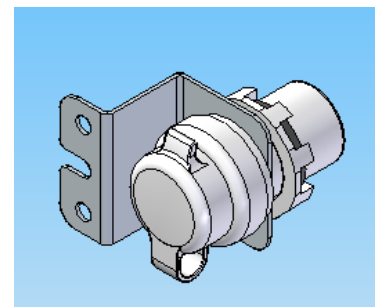

Fasten the RJ45 holder to the external ceiling element in the top left area

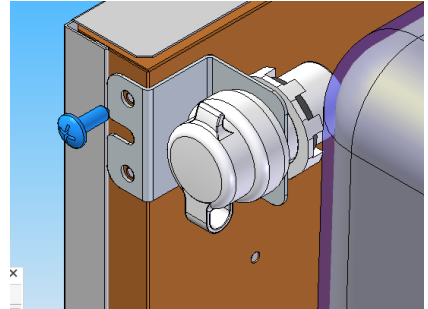

Connect the Ethernet cable to the RJ45 port

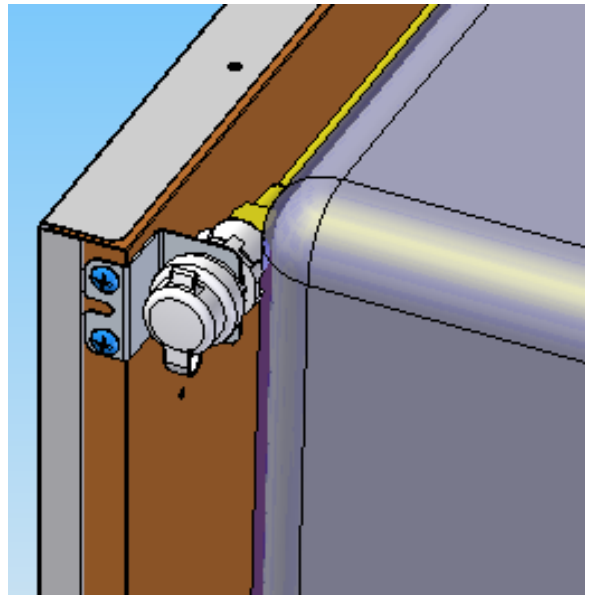

6080 cabinet model

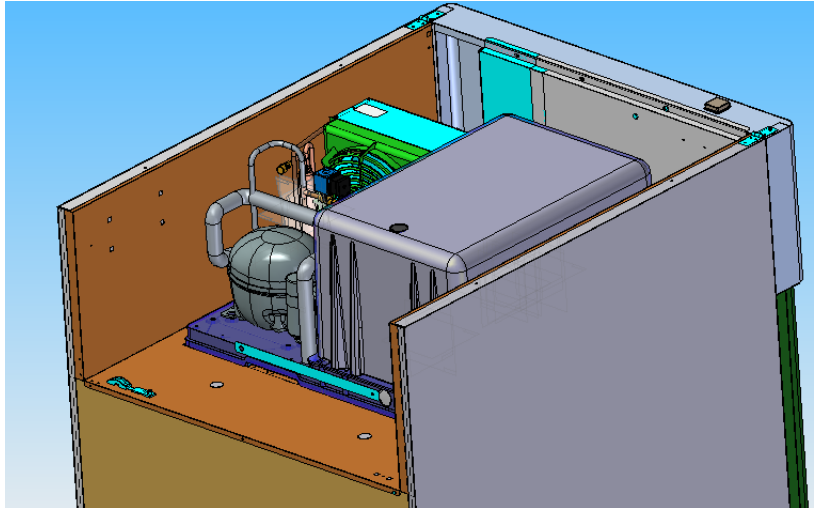

Take out the case body containing the Apolink board



Assemble the Oteco inserts on the holes on the side of the motor compartment

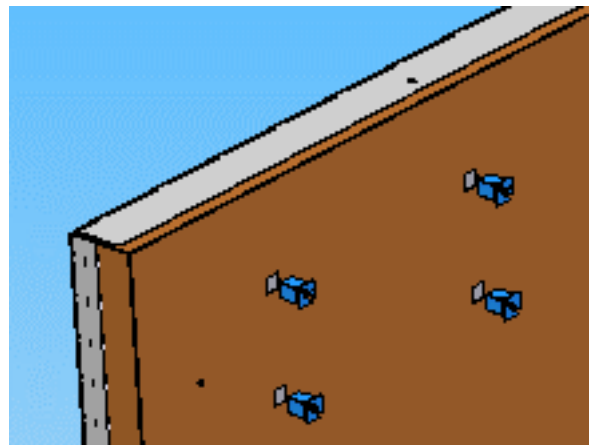

Take out the cables with the mate-n-lok connectors identified with R and S and connect them to the panel kit and Apolink board. Connect the Ethernet cable to the RJ45 port on the Apolink board



Fasten the case body to the external ceiling element using the supplied screws

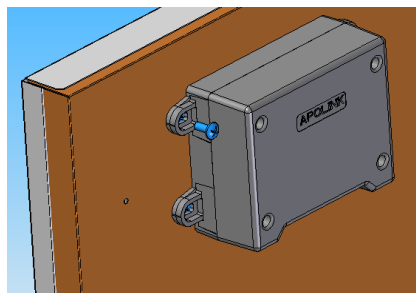

Take out the holder and assemble the RJ45 port

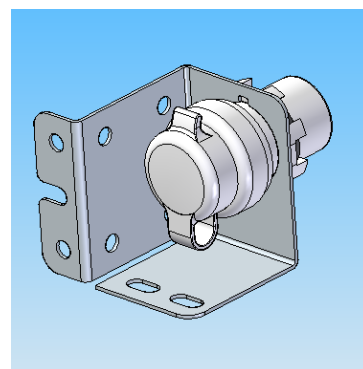

Fasten the RJ45 holder to the external ceiling element in the bottom left area

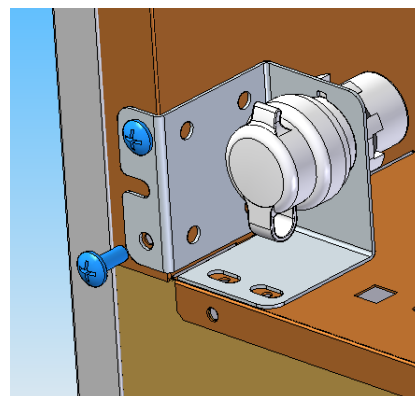

Connect the Ethernet cable to the RJ45 port

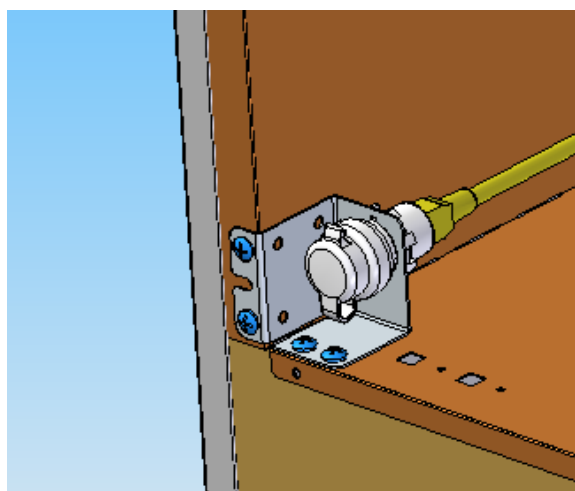

Ice cream parlour cabinet model

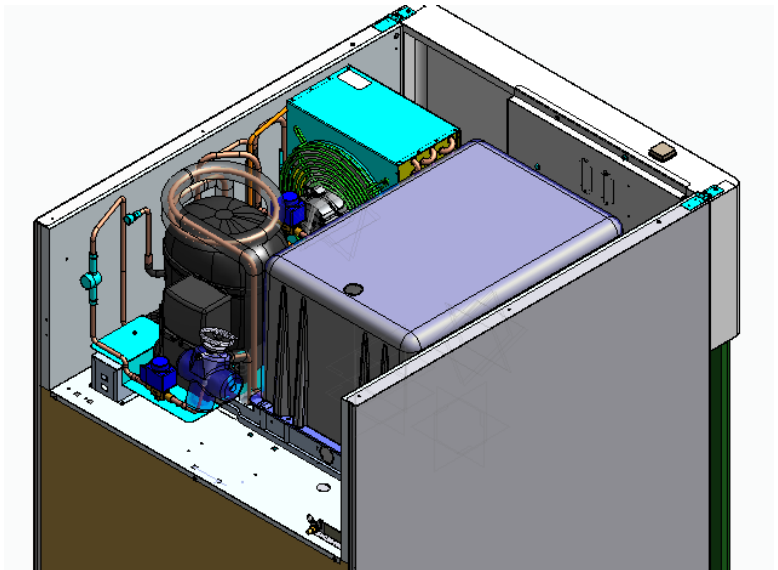

Take out the case body containing the Apolink board



Assemble the Oteco inserts on the holes on the side of the motor compartment



Take out the cables with the mate-n-lok connectors identified with R and S and connect them to the panel kit and Apolink board. Connect the Ethernet cable to the RJ45 port on the Apolink board



Fasten the case body to the external ceiling element using the supplied screws

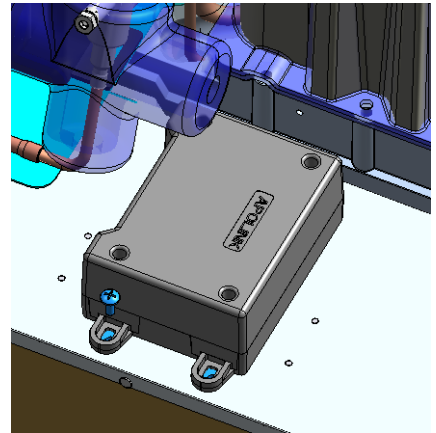

Take out the holder and assemble the RJ45 port

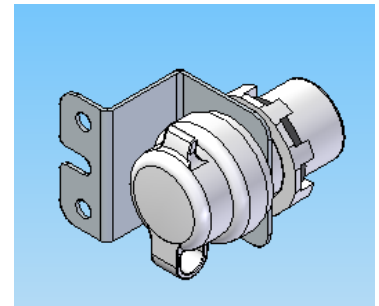

Fasten the RJ45 holder to the external ceiling element in the left area

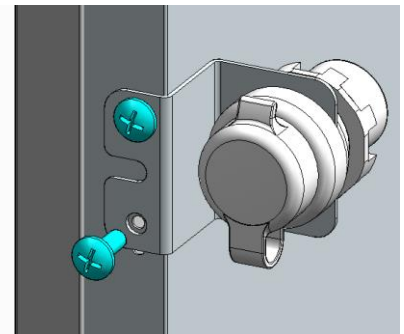

Connect the Ethernet cable to the RJ45 port

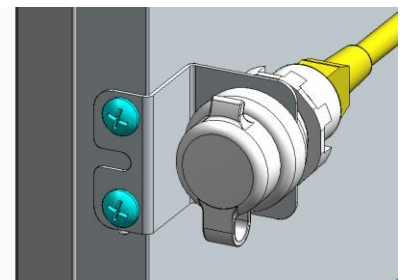

Switch on the machine

